

Capital Maintenance Program

05th St and 06th St, Myrtle St / Fort St, Maintenance and Two-Way Conversion - HB312 Project Boise

Priority: _____ of _____
Adjusted Benefit/Cost Ratio: _____

GIS # Prj # ITD Key #
Est Source Proj Mgr

Perform road rehabilitation and 2-way conversion of 05th St and 06th St in downtown Boise. Concept design, to be completed in 2017, will evaluate the two-way conversion to determine its ultimate configuration. Project funded all or in part through House Bill 312 funding.

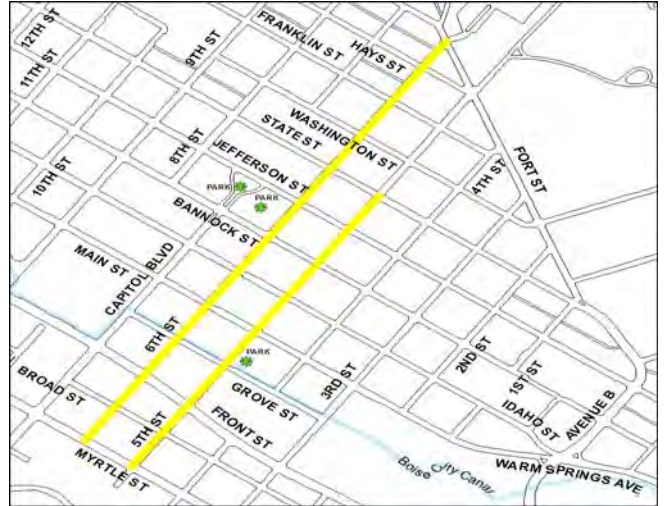

Programmed Expenditures			Project Costs	
Prof Services - DSN	\$279,000	2018	ACHD Share	\$2,035,000
Construction	\$1,450,000	2019	Plus Funding	\$0
Const Engineering	\$56,000	2019	Plus PriorCosts	
Traffic Materials	\$250,000	2019	Project Total	\$2,035,000
Programmed	\$2,035,000			

Arterial & Collector Capital Maintenance (2017) - HB312 Project

Priority: _____ of _____
Adjusted Benefit/Cost Ratio: _____

GIS # Prj # ITD Key #
Est Source Proj Mgr

Pavement rehabilitation and upgrade of adjacent pedestrian ramps on identified arterial and collector road segments as part of ACHD's Pavement Management Program. Project funded all or in part through House Bill 312 funding.

Columbia Rd, Locust Grove Rd / Eagle Rd
Ballantyne Ln, Floating Feather Rd / Beacon Light Rd
Ranch Dr, Eagle Rd / Eagle Hills Way
Park Blvd, Broadway Ave / Walnut St
Franklin St, Maple Ave / Coston St
McKinley St, Ave D / Maple Ave
Haines St, Franklin St / Shenandoah Dr

Programmed Expenditures			Project Costs	
Construction	\$58,000	2018	ACHD Share	\$58,000
Programmed	\$58,000		Plus Funding	\$0
			Plus PriorCosts	
			Project Total	\$58,000

Arterial & Collector Capital Maintenance (2018) - HB312 Project

Priority: _____ of _____
Adjusted Benefit/Cost Ratio: _____

GIS # Prj # ITD Key #
Est Source Proj Mgr

Pavement rehabilitation and upgrade of adjacent pedestrian ramps on identified arterial and collector road segments as part of ACHD's Pavement Management Program. Project funded all or in part through House Bill 312 funding. In-house design.

Black Cat Rd, Kuna Rd / Lake Hazel Rd
Black Cat Rd, Amity Rd / Victory Rd
Ten Mile Rd, Deer Flat Rd / Lake Hazel Rd
Franklin Rd, Beechwood Dr / Orchard St

Programmed Expenditures			Project Costs	
Construction	\$2,430,000	2018	ACHD Share	\$2,708,000
Construction	\$128,000	2019	Plus Funding	\$0
Const Engineering	\$150,000	2018	Plus PriorCosts	
Programmed	\$2,708,000		Project Total	\$2,708,000

Arterial & Collector Capital Maintenance (2020) - HB312 Project

Priority: of
Adjusted Benefit/Cost Ratio:

GIS # Prj # ITD Key #
 Est Source Proj Mgr

Specific road segments to be determined.

Pavement rehabilitation and upgrade of adjacent pedestrian ramps on identified arterial and collector road segments as part of ACHD's Pavement Management Program. Project funded all or in part through House Bill 312 funding. In-house design.

Programmed Expenditures			Project Costs	
Prof Services - DSN	\$50,000	2019	ACHD Share	\$1,950,000
Construction	\$1,900,000	2020	Plus Funding	\$0
Programmed	\$1,950,000		Plus PriorCosts	
			Project Total	\$1,950,000

Arterial & Collector Capital Maintenance (2021) - HB312 Project

Priority: of
Adjusted Benefit/Cost Ratio:

GIS # Prj # ITD Key #
 Est Source Proj Mgr

Specific road segments to be determined.

Pavement rehabilitation and upgrade of adjacent pedestrian ramps on identified arterial and collector road segments as part of ACHD's Pavement Management Program. Project funded all or in part through House Bill 312 funding.

Programmed Expenditures			Project Costs	
Prof Services - DSN	\$330,000	2020	ACHD Share	\$3,333,000
Construction	\$3,003,000	2021	Plus Funding	\$0
Programmed	\$3,333,000		Plus PriorCosts	
			Project Total	\$3,333,000

Arterial & Collector Capital Maintenance (2022) - HB312 Project

Priority: of
Adjusted Benefit/Cost Ratio:

GIS # Prj # ITD Key #
 Est Source Proj Mgr

Specific road segments to be determined.

Pavement rehabilitation and upgrade of adjacent pedestrian ramps on identified arterial and collector road segments as part of ACHD's Pavement Management Program. Project funded all or in part through House Bill 312 funding.

Programmed Expenditures			Project Costs	
Prof Services - DSN	\$360,000	2021	ACHD Share	\$3,610,000
Construction	\$3,250,000	2022	Plus Funding	\$0
Programmed	\$3,610,000		Plus PriorCosts	
			Project Total	\$3,610,000

Arterial & Collector Capital Maintenance (2023) - HB312 Project

Priority: of
Adjusted Benefit/Cost Ratio:

GIS # Prj # ITD Key #
 Est Source Proj Mgr

Specific road segments to be determined.

Pavement rehabilitation and upgrade of adjacent pedestrian ramps on identified arterial and collector road segments as part of ACHD's Pavement Management Program. Project funded all or in part through House Bill 312 funding.

Programmed Expenditures			Project Costs	
Prof Services - DSN	\$275,000	2022	ACHD Share	\$2,775,000
Construction	\$2,500,000	PD	Plus Funding	\$0
Programmed	\$2,775,000		Plus PriorCosts	
			Project Total	\$2,775,000

Arterial & Collector Capital Maintenance (2024) - HB312 Project

Priority: of
Adjusted Benefit/Cost Ratio:

GIS # Prj # ITD Key #
 Est Source Proj Mgr

Specific road segments to be determined.

Pavement rehabilitation and upgrade of adjacent pedestrian ramps on identified arterial and collector road segments as part of ACHD's Pavement Management Program. Project funded all or in part through House Bill 312 funding.

Programmed Expenditures			Project Costs	
Prof Services - DSN	\$412,000	PD	ACHD Share	\$4,165,000
Construction	\$3,753,000	PD	Plus Funding	\$0
Programmed	\$4,165,000		Plus PriorCosts	
			Project Total	\$4,165,000

Bogus Basin Road Safety, Maintenance, and Trail Head

Priority: of ****TIP****
Adjusted Benefit/Cost Ratio:

GIS # Prj # ITD Key #
 Est Source Proj Mgr

Federal aid project to rehabilitate and enhance safety to Bogus Basin Rd from milepost 9 to milepost 16.2, including roadway maintenance, concrete curbing, guardrail/barrier extensions/replacements, additional signage, improving drainage, improvements to existing pullouts and construction of a new trailhead. Project to be completed in partnership with the Boise National Forest (BNF).

Programmed Expenditures			Project Costs	
Prof Services - DSN	\$36,000	2018	ACHD Share	\$669,000
Prof Services - DSN	\$39,000	2019	Plus Funding	\$4,328,000
Survey	\$50,000	2018	Plus PriorCosts	
Construction	\$4,397,000	2018	Project Total	\$4,997,000
Construction	\$325,000	2019		
Const Engineering	\$150,000	2018		
Programmed	\$4,997,000			



Cul-de-Sac (2018) - HB312 Project

Priority: of
Adjusted Benefit/Cost Ratio:

GIS # Prj # ITD Key #
Est Source Proj Mgr

Rehabilitate cul-de-sacs in Maintenance Zone 6 as part of ACHD's Pavement Management Program. Project funded all or in part through House Bill 312 funding.

Programmed Expenditures			Project Costs	
Construction	\$300,000	2018	ACHD Share	\$400,000
Const Engineering	\$100,000	2018	Plus Funding	\$0
Programmed	\$400,000		Plus PriorCosts	
			Project Total	\$400,000



Cul-de-Sac (2019A) - HB312 Project

Priority: of
Adjusted Benefit/Cost Ratio:

GIS # Prj # ITD Key #
Est Source Proj Mgr

Rehabilitate cul-de-sacs in Maintenance Zone 1 as part of ACHD's Pavement Management Program. Project funded all or in part through House Bill 312 funding.

Programmed Expenditures			Project Costs	
Construction	\$300,000	2019	ACHD Share	\$300,000
Programmed	\$300,000		Plus Funding	\$0
			Plus PriorCosts	
			Project Total	\$300,000



Cul-de-Sac (2019B) - HB312 Project

Priority: of
Adjusted Benefit/Cost Ratio:

GIS # Prj # ITD Key #
Est Source Proj Mgr

Rehabilitate cul-de-sacs in Maintenance Zone 2 as part of ACHD's Pavement Management Program. Project funded all or in part through House Bill 312 funding.

Programmed Expenditures			Project Costs	
Construction	\$452,000	2019	ACHD Share	\$452,000
Programmed	\$452,000		Plus Funding	\$0
			Plus PriorCosts	
			Project Total	\$452,000

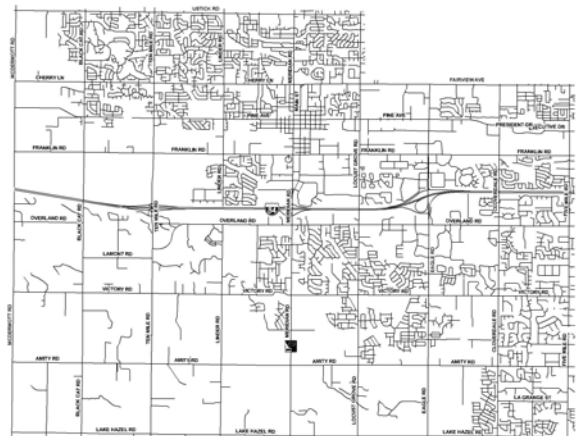

Cul-de-Sac (2020) - HB312 Project

Priority: of
Adjusted Benefit/Cost Ratio:

GIS # Prj # ITD Key #
Est Source Proj Mgr

Rehabilitate cul-de-sacs in Maintenance Zone 3 as part of ACHD's Pavement Management Program. Project funded all or in part through House Bill 312 funding.

Programmed Expenditures			Project Costs	
Construction	\$400,000	2020	ACHD Share	\$400,000
Programmed	\$400,000		Plus Funding	\$0
			Plus PriorCosts	
			Project Total	\$400,000

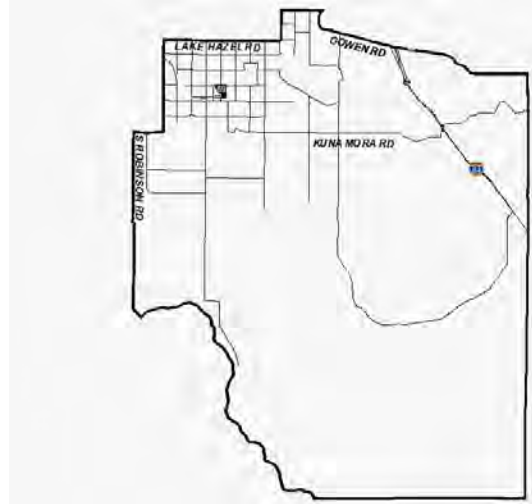

Cul-de-Sac (2021) - HB312 Project

Priority: of
Adjusted Benefit/Cost Ratio:

GIS # Prj # ITD Key #
Est Source Proj Mgr

Rehabilitate cul-de-sacs in Maintenance Zone 4 as part of ACHD's Pavement Management Program. Project funded all or in part through House Bill 312 funding.

Programmed Expenditures			Project Costs	
Construction	\$400,000	2021	ACHD Share	\$400,000
Programmed	\$400,000		Plus Funding	\$0
			Plus PriorCosts	
			Project Total	\$400,000



Cul-de-Sac (2022) - HB312 Project

Priority: of
Adjusted Benefit/Cost Ratio:

GIS # Prj # ITD Key #
Est Source Proj Mgr

Rehabilitate cul-de-sacs in Maintenance Zone 5 as part of ACHD's Pavement Management Program. Project funded all or in part through House Bill 312 funding.

Programmed Expenditures			Project Costs	
Construction	\$400,000	2022	ACHD Share	\$400,000
Programmed	\$400,000		Plus Funding	\$0
			Plus PriorCosts	
			Project Total	\$400,000



Cul-de-Sac (2023) - HB312 Project

Priority: of
Adjusted Benefit/Cost Ratio:

GIS # Prj # ITD Key #
 Est Source Proj Mgr

Rehabilitate cul-de-sacs in Maintenance Zone 6 as part of ACHD's Pavement Management Program. Project funded all or in part through House Bill 312 funding.

Programmed Expenditures			Project Costs	
Construction	\$400,000	PD	ACHD Share	\$400,000
Programmed	\$400,000		Plus Funding	\$0
			Plus PriorCosts	
			Project Total	\$400,000



Cul-de-Sac (2024) - HB312 Project

Priority: of
Adjusted Benefit/Cost Ratio:

GIS # Prj # ITD Key #
 Est Source Proj Mgr

Rehabilitate cul-de-sacs in Maintenance Zone 1 as part of ACHD's Pavement Management Program. Project funded all or in part through House Bill 312 funding.

Programmed Expenditures			Project Costs	
Construction	\$400,000	PD	ACHD Share	\$400,000
Programmed	\$400,000		Plus Funding	\$0
			Plus PriorCosts	
			Project Total	\$400,000



Downtown Boise Implementation (2018) - HB312 Project Boise

Priority: of
Adjusted Benefit/Cost Ratio:

GIS # Prj # ITD Key #
 Est Source Proj Mgr

Perform road rehabilitation of select streets in downtown Boise in concert with CCDC and other projects in accordance with the Downtown Boise Implementation Plan. Project funded all or in part through House Bill 312 funding.

Programmed Expenditures			Project Costs	
Prof Services - DSN	\$15,000	2018	ACHD Share	\$1,146,000
Construction	\$1,059,000	2018	Plus Funding	\$0
Construction	\$55,000	2019	Plus PriorCosts	
Const Engineering	\$17,000	2018	Project Total	\$1,146,000
Programmed	\$1,146,000			

- 2nd St, Myrtle St / Front St
- 4th St, S/O Myrtle St / Broad St
- 4th St, Grove St / State St
- 8th St, Myrtle St / Broad St
- Ave A, Myrtle St / Front St
- Broad St, 9th St / 8th St
- Front St, 16th St / 13th St
- River St, 9th St / Capitol Blvd

Downtown Boise Implementation (2019) - HB312 Project Boise

Priority: of
Adjusted Benefit/Cost Ratio:

GIS # Prj # ITD Key #
 Est Source Proj Mgr

Perform road rehabilitation of select streets in downtown Boise in concert with CCDC and other projects in accordance with the Downtown Boise Implementation Plan. Project includes installation of an accessible pedestrian signal at 8th St and Bannock St. Project funded all or in part through House Bill 312 funding.

11th St, Bannock St / State St
11th St, River St / Myrtle St
11th St, Front St / Main St
15th St, Front St / State St
16th St, Front St / State St
8th St, Bannock St / State St
Bannock St, 9th St / 2nd St
Bannock St, 16th St / 15th St

Programmed Expenditures			Project Costs	
Prof Services - DSN	\$177,000	2018	ACHD Share	\$1,668,000
Construction	\$1,420,000	2019	Plus Funding	\$0
Const Engineering	\$56,000	2019	Plus PriorCosts	
Traffic Materials	\$15,000	2019	Project Total	\$1,668,000
Programmed	\$1,668,000			

Downtown Boise Implementation (2020) - HB312 Project Boise

Priority: of
Adjusted Benefit/Cost Ratio:

GIS # Prj # ITD Key #
 Est Source Proj Mgr

Perform road rehabilitation of select streets in downtown Boise in concert with CCDC and other projects in accordance with the Downtown Boise Implementation Plan. Project funded all or in part through House Bill 312 funding.

9th St, Bannock St / State St
9th St, University Dr / Front St
10th St, Front St / Idaho St
Grove St, 16th St / 9th St

Programmed Expenditures			Project Costs	
Prof Services - DSN	\$442,000	2019	ACHD Share	\$3,270,000
Construction	\$2,780,000	2020	Plus Funding	\$0
Const Engineering	\$48,000	2020	Plus PriorCosts	
Programmed	\$3,270,000		Project Total	\$3,270,000

Federal Aid Capital Maintenance (2017)

Priority: of ****TIP****
Adjusted Benefit/Cost Ratio:

GIS # Prj # ITD Key #
 Est Source Proj Mgr

Pavement rehabilitation and upgrade of adjacent pedestrian ramps on identified arterial and collector road segments. Projects selected as part of ACHD's Pavement Management Program.

3rd St, Myrtle St / Front St
3rd St, Jefferson St / Fort St
4th St, State St / Washington St
11th St, Main St / Bannock St
11th St, Myrtle St / Front St
Amity Rd, Production St / Market St
Cherry Ln, Ten Mile Rd / Meridian Rd
Collister Dr, Hill Rd / Quail Ridge Dr
Curtis Rd, Morris Hill Rd / I-84
Harrison Blvd, Hays St / Hill Rd
Irene St, 33rd St / Harrison Blvd
River Run Dr, Parkcenter Blvd / Parkcenter Blvd
Rose Hill St, Roosevelt St / Vista Ave
Seaman Gulch Rd, Hill Rd Pkwy / Landfill Entrance
Sycamore Dr, State St / Taft St
Taft St, 32nd St / 28th St
Warm Springs Ave, Starcrest Dr / Starview Dr
Warm Springs Ave, Eckert Rd / Hwy 21

Programmed Expenditures			Project Costs	
Const Engineering	\$430,000	2018	ACHD Share	\$32,000
Programmed	\$430,000		Plus Funding	\$398,000
			Plus PriorCosts	
			Project Total	\$430,000

Federal Aid Capital Maintenance (2019) - Local

Priority: of ****TIP****
Adjusted Benefit/Cost Ratio:

GIS # Prj # ITD Key #
Est Source Proj Mgr

**Cherry Ln, Shoshone St / Broxon St
Elder St, Owyhee St / Vista Ave
Owyhee St, Elder St / Cherry Ln**

Pavement rehabilitation and upgrade of adjacent pedestrian ramps on identified arterial and collector road segments. Projects selected as part of ACHD's Pavement Management Program.

Programmed Expenditures			Project Costs	
Prof Services - DSN	\$20,000	2018	ACHD Share	\$350,000
Construction	\$300,000	2019	Plus Funding	\$0
Const Engineering	\$30,000	2019	Plus PriorCosts	
Programmed	\$350,000		Project Total	\$350,000

Federal Aid Capital Maintenance (2019) - Phase 1

Priority: of ****TIP****
Adjusted Benefit/Cost Ratio:

GIS # Prj # ITD Key #
Est Source Proj Mgr

**Amity Rd, Enterprise St / Production St
Annett St, Victory Rd / Targee St
Boise Ave, Leadville Ave / Gekeler Ln
Division Ave, Boise Ave / Beacon St
Enterprise St, Amity Rd / Commerce Ave
Fairview Ave, Locust Grove Rd / Cloverdale Rd
Latah St, Overland Rd / Alpine St
Linden St, Broadway Ave / Gekeler Ln
Surprise Way, Amity Rd / Hwy 21**

Pavement rehabilitation and upgrade of adjacent pedestrian ramps on identified arterial and collector road segments. Projects selected as part of ACHD's Pavement Management Program.

Programmed Expenditures			Project Costs	
Prof Services - DSN	\$200,000	2018	ACHD Share	\$477,000
Construction	\$322,000	2019	Plus Funding	\$4,761,000
Const Engineering	\$250,000	2019	Plus PriorCosts	
Programmed	\$772,000		Project Total	\$5,238,000

Federal Aid Capital Maintenance (2019) - Phase 2

Priority: of ****TIP****
Adjusted Benefit/Cost Ratio:

GIS # Prj # ITD Key #
Est Source Proj Mgr

**Emerald St, Cole Rd / Orchard St
Grand Forest Dr, Gowen Rd / Rock Rose Pl
Lake Forest Dr, Federal Way / Summersweet Dr
Orchard St, Overland Rd / Franklin Rd**

Pavement rehabilitation and upgrade of adjacent pedestrian ramps on identified arterial and collector road segments. Projects selected as part of ACHD's Pavement Management Program.

Programmed Expenditures			Project Costs	
Prof Services - DSN	\$77,000	2018	ACHD Share	\$211,000
Construction	\$135,000	2019	Plus Funding	\$2,022,000
Const Engineering	\$100,000	2019	Plus PriorCosts	
Programmed	\$312,000		Project Total	\$2,233,000

Federal Aid Capital Maintenance (2020) - Local

Priority: of ****TIP****
Adjusted Benefit/Cost Ratio:

GIS # Prj # ITD Key #
Est Source Proj Mgr

Owyhee St, Cherry Ln / Overland Rd

Pavement rehabilitation and upgrade of adjacent pedestrian ramps on identified arterial and collector road segments. Projects selected as part of ACHD's Pavement Management Program.

Programmed Expenditures			Project Costs	
Prof Services - DSN	\$20,000	2018	ACHD Share	\$320,000
Construction	\$300,000	2020	Plus Funding	\$0
Programmed	\$320,000		Plus PriorCosts	
			Project Total	\$320,000

Federal Aid Capital Maintenance (2020) - Phase 1

Priority: of ****TIP****
Adjusted Benefit/Cost Ratio:

GIS # Prj # ITD Key #
Est Source Proj Mgr

**13th St, Alturas St / Brumback St
Beacon Light Rd, SH 16 / Ballantyne Ln
Cole Rd, Lake Hazel Rd / Latigo Dr
Floating Feather Rd, Lanewood Rd / Linder Rd
Hill Rd Pkwy, Horseshoe Bend Rd / Seaman Gulch Rd
Horseshoe Bend Rd, State St / Cemetery Entrance
Locust Grove Rd, Ustick Rd / McMillan Rd
Pine St, Linder Rd / Meridian Rd
Technology Way, Columbia Rd / SH 21**

Pavement rehabilitation and upgrade of adjacent pedestrian ramps on identified arterial and collector road segments. Projects selected as part of ACHD's Pavement Management Program.

Programmed Expenditures			Project Costs	
Prof Services - DSN	\$265,000	2018	ACHD Share	\$425,000
Prof Services - DSN	\$253,000	2019	Plus Funding	\$5,370,000
Construction	\$337,000	2020	Plus PriorCosts	
Const Engineering	\$50,000	2020	Project Total	\$5,795,000
Programmed	\$905,000			

Federal Aid Capital Maintenance (2020) - Phase 2

Priority: of ****TIP****
Adjusted Benefit/Cost Ratio:

GIS # Prj # ITD Key #
Est Source Proj Mgr

Collister Dr, Quail Ridge Dr / North End

Pavement rehabilitation and upgrade of adjacent pedestrian ramps on identified arterial and collector road segments. Projects selected as part of ACHD's Pavement Management Program.

Programmed Expenditures			Project Costs	
Prof Services - DSN	\$226,000	2018	ACHD Share	\$182,000
Construction	\$144,000	2020	Plus Funding	\$2,306,000
Const Engineering	\$22,000	2020	Plus PriorCosts	
Programmed	\$392,000		Project Total	\$2,488,000

Federal Aid Capital Maintenance (2021) - Local

Priority: of ****TIP****
Adjusted Benefit/Cost Ratio:

GIS # Prj # ITD Key #
Est Source Proj Mgr

Specific road segments to be determined.

Pavement rehabilitation and upgrade of adjacent pedestrian ramps on identified arterial and collector road segments. Projects selected as part of ACHD's Pavement Management Program.

Programmed Expenditures			Project Costs	
Prof Services - DSN	\$21,000	2019	ACHD Share	\$321,000
Construction	\$300,000	2021	Plus Funding	\$0
Programmed	\$321,000		Plus PriorCosts	
			Project Total	\$321,000

Federal Aid Capital Maintenance (2021) - Phase 1

Priority: of ****TIP****
Adjusted Benefit/Cost Ratio:

GIS # Prj # ITD Key #
Est Source Proj Mgr

Specific road segments to be determined.

Pavement rehabilitation and upgrade of adjacent pedestrian ramps on identified arterial and collector road segments. Projects selected as part of ACHD's Pavement Management Program.

Programmed Expenditures			Project Costs	
Prof Services - DSN	\$515,000	2019	ACHD Share	\$383,000
Construction	\$300,000	2021	Plus Funding	\$4,833,000
Const Engineering	\$45,000	2021	Plus PriorCosts	
Programmed	\$860,000		Project Total	\$5,216,000

Federal Aid Capital Maintenance (2021) - Phase 2

Priority: of ****TIP****
Adjusted Benefit/Cost Ratio:

GIS # Prj # ITD Key #
Est Source Proj Mgr

Specific road segments to be determined.

Pavement rehabilitation and upgrade of adjacent pedestrian ramps on identified arterial and collector road segments. Projects selected as part of ACHD's Pavement Management Program.

Programmed Expenditures			Project Costs	
Prof Services - DSN	\$222,000	2019	ACHD Share	\$179,000
Construction	\$141,000	2021	Plus Funding	\$2,254,000
Const Engineering	\$21,000	2021	Plus PriorCosts	
Programmed	\$384,000		Project Total	\$2,433,000

Federal Aid Capital Maintenance (2022) - Local

Priority: of ****TIP****
Adjusted Benefit/Cost Ratio:

GIS # Prj # ITD Key #
Est Source Proj Mgr

Specific road segments to be determined.

Pavement rehabilitation and upgrade of adjacent pedestrian ramps on identified arterial and collector road segments. Projects selected as part of ACHD's Pavement Management Program.

Programmed Expenditures			Project Costs	
Prof Services - DSN	\$20,000	2020	ACHD Share	\$320,000
Construction	\$300,000	2022	Plus Funding	\$0
Programmed	\$320,000		Plus PriorCosts	
			Project Total	\$320,000

Federal Aid Capital Maintenance (2022) - Phase 1

Priority: of ****TIP****
Adjusted Benefit/Cost Ratio:

GIS # Prj # ITD Key #
Est Source Proj Mgr

Specific road segments to be determined.

Pavement rehabilitation and upgrade of adjacent pedestrian ramps on identified arterial and collector road segments. Projects selected as part of ACHD's Pavement Management Program.

Programmed Expenditures			Project Costs	
Prof Services - DSN	\$554,000	2020	ACHD Share	\$427,000
Construction	\$336,000	2022	Plus Funding	\$5,388,000
Const Engineering	\$50,000	2022	Plus PriorCosts	
Programmed	\$940,000		Project Total	\$5,815,000

Federal Aid Capital Maintenance (2022) - Phase 2

Priority: of ****TIP****
Adjusted Benefit/Cost Ratio:

GIS # Prj # ITD Key #
Est Source Proj Mgr

Specific road segments to be determined.

Pavement rehabilitation and upgrade of adjacent pedestrian ramps on identified arterial and collector road segments. Projects selected as part of ACHD's Pavement Management Program.

Programmed Expenditures			Project Costs	
Prof Services - DSN	\$217,000	2020	ACHD Share	\$175,000
Construction	\$138,000	2022	Plus Funding	\$2,203,000
Const Engineering	\$21,000	2022	Plus PriorCosts	
Programmed	\$376,000		Project Total	\$2,378,000

Federal Aid Capital Maintenance (2023) - Local

Priority: of ****TIP****
Adjusted Benefit/Cost Ratio:

GIS # Prj # ITD Key #
Est Source Proj Mgr

Specific road segments to be determined.

Pavement rehabilitation and upgrade of adjacent pedestrian ramps on identified arterial and collector road segments. Projects selected as part of ACHD's Pavement Management Program.

Programmed Expenditures			Project Costs	
Prof Services - DSN	\$20,000	2021	ACHD Share	\$320,000
Construction	\$300,000	PD	Plus Funding	\$0
Programmed	\$320,000		Plus PriorCosts	
			Project Total	\$320,000

Federal Aid Capital Maintenance (2023) - Phase 1

Priority: of ****TIP****
Adjusted Benefit/Cost Ratio:

GIS # Prj # ITD Key #
Est Source Proj Mgr

Specific road segments to be determined.

Pavement rehabilitation and upgrade of adjacent pedestrian ramps on identified arterial and collector road segments. Projects selected as part of ACHD's Pavement Management Program.

Programmed Expenditures			Project Costs	
Prof Services - DSN	\$503,000	2021	ACHD Share	\$419,000
Construction	\$333,000	PD	Plus Funding	\$5,298,000
Const Engineering	\$50,000	PD	Plus PriorCosts	
Programmed	\$886,000		Project Total	\$5,717,000

Federal Aid Capital Maintenance (2023) - Phase 2

Priority: of ****TIP****
Adjusted Benefit/Cost Ratio:

GIS # Prj # ITD Key #
Est Source Proj Mgr

Specific road segments to be determined.

Pavement rehabilitation and upgrade of adjacent pedestrian ramps on identified arterial and collector road segments. Projects selected as part of ACHD's Pavement Management Program.

Programmed Expenditures			Project Costs	
Prof Services - DSN	\$217,000	2021	ACHD Share	\$175,000
Construction	\$138,000	PD	Plus Funding	\$2,203,000
Const Engineering	\$21,000	PD	Plus PriorCosts	
Programmed	\$376,000		Project Total	\$2,378,000

Federal Aid Capital Maintenance (2024) - Local

Priority: of ****TIP****
Adjusted Benefit/Cost Ratio:

GIS # Prj # ITD Key #
Est Source Proj Mgr

Specific road segments to be determined.

Pavement rehabilitation and upgrade of adjacent pedestrian ramps on identified arterial and collector road segments. Projects selected as part of ACHD's Pavement Management Program.

Programmed Expenditures			Project Costs	
Prof Services - DSN	\$20,000	2022	ACHD Share	\$320,000
Construction	\$300,000	PD	Plus Funding	\$0
Programmed	\$320,000		Plus PriorCosts	
			Project Total	\$320,000

Federal Aid Capital Maintenance (2024) - Phase 1

Priority: of ****TIP****
Adjusted Benefit/Cost Ratio:

GIS # Prj # ITD Key #
Est Source Proj Mgr

Specific road segments to be determined.

Pavement rehabilitation and upgrade of adjacent pedestrian ramps on identified arterial and collector road segments. Projects selected as part of ACHD's Pavement Management Program.

Programmed Expenditures			Project Costs	
Prof Services - DSN	\$503,000	2022	ACHD Share	\$419,000
Construction	\$333,000	PD	Plus Funding	\$5,298,000
Const Engineering	\$50,000	PD	Plus PriorCosts	
Programmed	\$886,000		Project Total	\$5,717,000

Federal Aid Capital Maintenance (2024) - Phase 2

Priority: of ****TIP****
Adjusted Benefit/Cost Ratio:

GIS # Prj # ITD Key #
Est Source Proj Mgr

Specific road segments to be determined.

Pavement rehabilitation and upgrade of adjacent pedestrian ramps on identified arterial and collector road segments. Projects selected as part of ACHD's Pavement Management Program.

Programmed Expenditures			Project Costs	
Prof Services - DSN	\$217,000	2022	ACHD Share	\$175,000
Construction	\$138,000	PD	Plus Funding	\$2,203,000
Const Engineering	\$21,000	PD	Plus PriorCosts	
Programmed	\$376,000		Project Total	\$2,378,000

**Kuna Downtown Revitalization, Phase 1 - HB312 Project
Kuna**

Priority: of ****TIP****
Adjusted Benefit/Cost Ratio:

GIS # Prj # ITD Key #
Est Source Proj Mgr

Complete roadway maintenance on Main St, between Avenue A and Avenue C in coordination with the City of Kuna's Downtown Revitalization project. The City of Kuna will design, bid, and construct improvements. Project costs reflect only ACHD's contribution to the overall project. Project funded all or in part through House Bill 312 funding.

Programmed Expenditures			Project Costs	
Construction	\$200,000	2018	ACHD Share	\$200,000
Programmed	\$200,000		Plus Funding	\$0
			Plus PriorCosts	
			Project Total	\$200,000

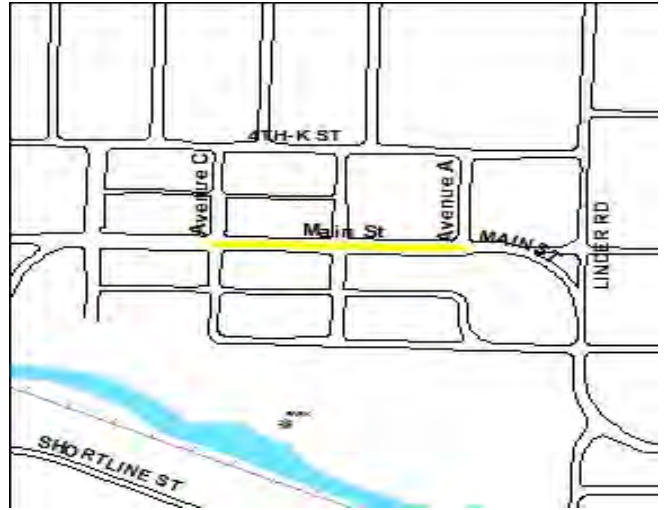

**Lake Hazel Rd Reclaim, Five Mile Rd / Maple Grove Rd - HB312 Project
Ada County**

Priority: of
Adjusted Benefit/Cost Ratio:

GIS # Prj # ITD Key #
Est Source Proj Mgr

Rehabilitate Lake Hazel Rd between Five Mile Rd and Maple Grove Rd as part of ACHD's Pavement Management Program. Project to include shoulder widening. Project funded all or in part through House Bill 312 funding. In-house design with minimal consultant services.

Programmed Expenditures			Project Costs	
Construction	\$50,000	2018	ACHD Share	\$50,000
Programmed	\$50,000		Plus Funding	\$0
			Plus PriorCosts	
			Project Total	\$50,000

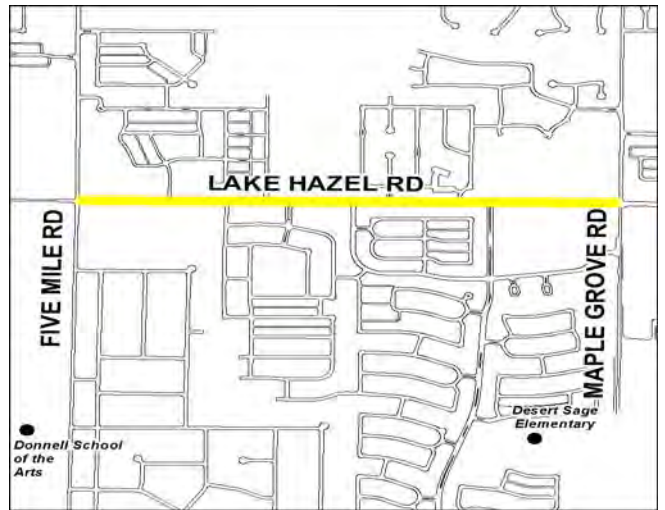

**Lake Hazel Rd Reclaim, Maple Grove Rd / Cole Rd - HB312 Project
Ada County**

Priority: of
Adjusted Benefit/Cost Ratio:

GIS # Prj # ITD Key #
Est Source Proj Mgr

Rehabilitate Lake Hazel Rd between Maple Grove Rd and Cole Rd as part of ACHD's Pavement Management Program. Project to include shoulder and turn lane widening. Project funded all or in part through House Bill 312 funding.

Programmed Expenditures			Project Costs	
Prof Services - DSN	\$50,000	2018	ACHD Share	\$564,000
RW Acquisition	\$2,000	2018	Plus Funding	\$0
Construction	\$505,000	2019	Plus PriorCosts	
Const Engineering	\$7,000	2019	Project Total	\$564,000
Programmed	\$564,000			



Main St and Idaho St, 16th St / Broadway Ave - HB312 Project Boise

Priority: of Adjusted Benefit/Cost Ratio:

GIS # Prj # ITD Key #

Est Source Proj Mgr

Rehabilitate Main St and Idaho St between 16th St and Broadway Ave as part of the Downtown Boise Implementation Plan. Project funded all or in part through House Bill 312 funding.

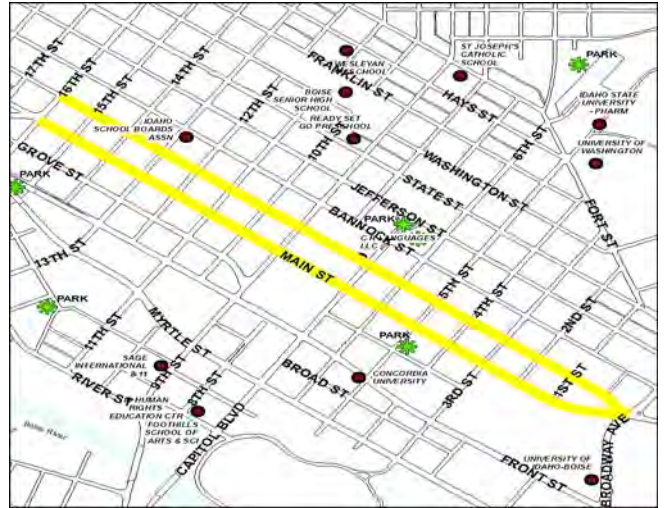

Programmed Expenditures			Project Costs	
Prof Services - DSN	\$175,000	2018	ACHD Share	\$1,814,000
Construction	\$1,600,000	2019	Plus Funding	\$0
Const Engineering	\$36,000	2019	Plus PriorCosts	
Utilities	\$3,000	2019	Project Total	\$1,814,000
Programmed	\$1,814,000			

Maintenance Crack Seal (2018) - HB312 Project

Priority: of Adjusted Benefit/Cost Ratio:

GIS # Prj # ITD Key #

Est Source Proj Mgr

Seal cracks in arterial and collector roadways in Preventative Maintenance Zone 1 as part of ACHD's Pavement Management Program. Project funded all or in part through House Bill 312 funding.



Programmed Expenditures			Project Costs	
Construction	\$450,000	2018	ACHD Share	\$450,000
Programmed	\$450,000		Plus Funding	\$0
			Plus PriorCosts	
			Project Total	\$450,000

Maintenance Crack Seal (2019) - HB312 Project

Priority: of Adjusted Benefit/Cost Ratio:

GIS # Prj # ITD Key #

Est Source Proj Mgr

Seal cracks in arterial and collector roadways in Preventative Maintenance Zone 2 as part of ACHD's Pavement Management Program. Project funded all or in part through House Bill 312 funding.

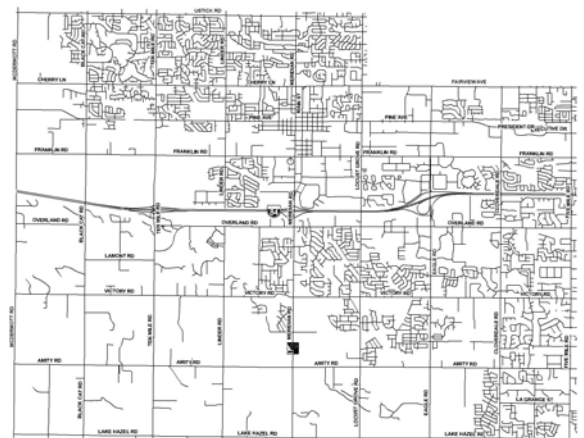

Programmed Expenditures			Project Costs	
Construction	\$325,000	2019	ACHD Share	\$325,000
Programmed	\$325,000		Plus Funding	\$0
			Plus PriorCosts	
			Project Total	\$325,000

Maintenance Crack Seal (2020) - HB312 Project

Priority: of
Adjusted Benefit/Cost Ratio:

GIS # Prj # ITD Key #
Est Source Proj Mgr

Seal cracks in arterial and collector roadways in Preventative Maintenance Zone 3 as part of ACHD's Pavement Management Program. Project funded all or in part through House Bill 312 funding.

Programmed Expenditures			Project Costs	
Construction	\$325,000	2020	ACHD Share	\$325,000
Programmed	\$325,000		Plus Funding	\$0
			Plus PriorCosts	
			Project Total	\$325,000

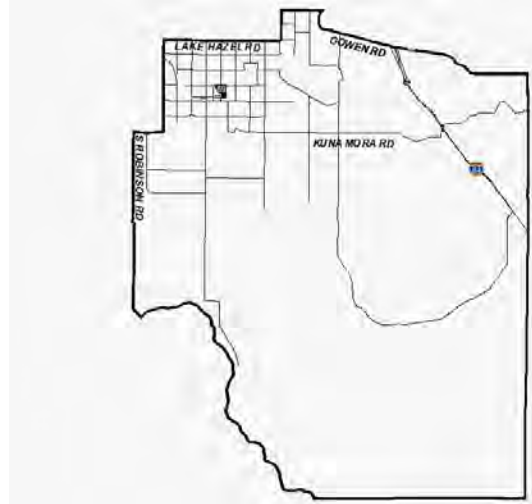

Maintenance Crack Seal (2021) - HB312 Project

Priority: of
Adjusted Benefit/Cost Ratio:

GIS # Prj # ITD Key #
Est Source Proj Mgr

Seal cracks in arterial and collector roadways in Preventative Maintenance Zone 4 as part of ACHD's Pavement Management Program. Project funded all or in part through House Bill 312 funding.

Programmed Expenditures			Project Costs	
Construction	\$325,000	2021	ACHD Share	\$325,000
Programmed	\$325,000		Plus Funding	\$0
			Plus PriorCosts	
			Project Total	\$325,000



Maintenance Crack Seal (2022) - HB312 Project

Priority: of
Adjusted Benefit/Cost Ratio:

GIS # Prj # ITD Key #
Est Source Proj Mgr

Seal cracks in arterial and collector roadways in Preventative Maintenance Zone 5 as part of ACHD's Pavement Management Program. Project funded all or in part through House Bill 312 funding.

Programmed Expenditures			Project Costs	
Construction	\$325,000	2022	ACHD Share	\$325,000
Programmed	\$325,000		Plus Funding	\$0
			Plus PriorCosts	
			Project Total	\$325,000



Maintenance Crack Seal (2023) - HB312 Project

Priority: of
Adjusted Benefit/Cost Ratio:

GIS # Prj # ITD Key #
Est Source Proj Mgr

Seal cracks in arterial and collector roadways in Preventative Maintenance Zone 6 as part of ACHD's Pavement Management Program. Project funded all or in part through House Bill 312 funding.

Programmed Expenditures			Project Costs	
Construction	\$325,000	PD	ACHD Share	\$325,000
Programmed	\$325,000		Plus Funding	\$0
			Plus PriorCosts	
			Project Total	\$325,000



Maintenance Crack Seal (2024) - HB312 Project

Priority: of
Adjusted Benefit/Cost Ratio:

GIS # Prj # ITD Key #
Est Source Proj Mgr

Seal cracks in arterial and collector roadways in Preventative Maintenance Zone 1 as part of ACHD's Pavement Management Program. Project funded all or in part through House Bill 312 funding.

Programmed Expenditures			Project Costs	
Construction	\$325,000	PD	ACHD Share	\$325,000
Programmed	\$325,000		Plus Funding	\$0
			Plus PriorCosts	
			Project Total	\$325,000



Microseal (2017) - HB312 Project

Priority: of
Adjusted Benefit/Cost Ratio:

GIS # Prj # ITD Key #
Est Source Proj Mgr

Microseal roadways as part of ACHD's Pavement Management Program. Project funded all or in part through House Bill 312 funding.

Programmed Expenditures			Project Costs	
Construction	\$11,000	2018	ACHD Share	\$11,000
Programmed	\$11,000		Plus Funding	\$0
			Plus PriorCosts	
			Project Total	\$11,000

- 13th St, Main St / State St
- 14th St, Front St / State St
- Bannock St, 9th St / 15th St
- Carlton Ave, Meridian Rd / Main St
- Idaho Ave, Meridian Rd / Main St
- Main St, King St / Fairview Ave
- State St, Meridian Rd / Main St
- Washington St, Meridian Rd / Main St

Microseal (2018) - HB312 ProjectPriority: of
Adjusted Benefit/Cost Ratio:GIS # Prj # ITD Key #
Est Source Proj Mgr **Specific road segments to be determined.**

Microseal roadways as part of ACHD's Pavement Management Program. Project funded all or in part through House Bill 312 funding.

Programmed Expenditures			Project Costs	
Construction	\$250,000	2018	ACHD Share	\$250,000
Programmed	\$250,000		Plus Funding	\$0
			Plus PriorCosts	
			Project Total	\$250,000

Microseal (2019) - HB312 ProjectPriority: of
Adjusted Benefit/Cost Ratio:GIS # Prj # ITD Key #
Est Source Proj Mgr **Fairview Ave, Garden St / 16th St
Main St, Garden St / 16th St**

Microseal roadways as part of ACHD's Pavement Management Program. Project includes lane restriping for the addition of on-street parking on Fairview Ave and Main St, from Garden St to 16th St, in accordance with the Fairview and Main Local Streets Improvement Plan. Main Project funded all or in part through House Bill 312 funding.

Programmed Expenditures			Project Costs	
Construction	\$250,000	2019	ACHD Share	\$250,000
Programmed	\$250,000		Plus Funding	\$0
			Plus PriorCosts	
			Project Total	\$250,000

Microseal (2020) - HB312 ProjectPriority: of
Adjusted Benefit/Cost Ratio:GIS # Prj # ITD Key #
Est Source Proj Mgr **Specific road segments to be determined.**

Microseal roadways as part of ACHD's Pavement Management Program. Project funded all or in part through House Bill 312 funding.

Programmed Expenditures			Project Costs	
Construction	\$400,000	2020	ACHD Share	\$400,000
Programmed	\$400,000		Plus Funding	\$0
			Plus PriorCosts	
			Project Total	\$400,000

Microseal (2021) - HB312 ProjectPriority: of
Adjusted Benefit/Cost Ratio:GIS # Prj # ITD Key #
Est Source Proj Mgr **Specific road segments to be determined.**

Microseal roadways as part of ACHD's Pavement Management Program. Project funded all or in part through House Bill 312 funding.

Programmed Expenditures			Project Costs	
Construction	\$400,000	2021	ACHD Share	\$400,000
Programmed	\$400,000		Plus Funding	\$0
			Plus PriorCosts	
			Project Total	\$400,000

Microseal (2022) - HB312 ProjectPriority: of
Adjusted Benefit/Cost Ratio:GIS # Prj # ITD Key #
Est Source Proj Mgr **Specific road segments to be determined.**

Microseal roadways as part of ACHD's Pavement Management Program. Project funded all or in part through House Bill 312 funding.

Programmed Expenditures			Project Costs	
Construction	\$400,000	2022	ACHD Share	\$400,000
Programmed	\$400,000		Plus Funding	\$0
			Plus PriorCosts	
			Project Total	\$400,000

Microseal (2023) - HB312 ProjectPriority: of
Adjusted Benefit/Cost Ratio:GIS # Prj # ITD Key #
Est Source Proj Mgr **Specific road segments to be determined.**

Microseal roadways as part of ACHD's Pavement Management Program. Project funded all or in part through House Bill 312 funding.

Programmed Expenditures			Project Costs	
Construction	\$400,000	PD	ACHD Share	\$400,000
Programmed	\$400,000		Plus Funding	\$0
			Plus PriorCosts	
			Project Total	\$400,000

Microseal (2024) - HB312 Project

Priority: of
Adjusted Benefit/Cost Ratio:

GIS # Prj # ITD Key #
 Est Source Proj Mgr

Specific road segments to be determined.

Microseal roadways as part of ACHD's Pavement Management Program. Project funded all or in part through House Bill 312 funding.

Programmed Expenditures			Project Costs	
Construction	\$400,000	PD	ACHD Share	\$400,000
Programmed	\$400,000		Plus Funding	\$0
			Plus PriorCosts	
			Project Total	\$400,000

**Residential Capital Maintenance (2017) - HB312 Project
Ada County / Boise / Kuna / Meridian / Eagle / Garden City / Star**

Priority: of
Adjusted Benefit/Cost Ratio:

GIS # Prj # ITD Key #
 Est Source Proj Mgr

**Amyx Jay Subdivision, Boise
 William Harris Subdivision, Boise
 Eagleson Park No. 4 Subdivision, Boise
 Sorenson No. 3 Subdivision, Boise
 Southwestern Subdivision, Boise
 Fox Meadow Subdivision, Boise
 Butler Sunview Estates, Kuna**

Pavement rehabilitation and upgrade of adjacent pedestrian ramps on specified residential street segments. Segments to be identified as part of ACHD's Pavement Management Program. Project funded all or in part through House Bill 312 funding.

Programmed Expenditures			Project Costs	
Construction	\$120,000	2018	ACHD Share	\$120,000
Programmed	\$120,000		Plus Funding	\$0
			Plus PriorCosts	
			Project Total	\$120,000

**Residential Capital Maintenance (2018) - HB312 Project
Ada County / Boise / Kuna / Meridian / Eagle / Garden City / Star**

Priority: of
Adjusted Benefit/Cost Ratio:

GIS # Prj # ITD Key #
 Est Source Proj Mgr

**North End, Boise – Various Segments
 East End, Boise – Various Segments**

Pavement rehabilitation and upgrade of adjacent pedestrian ramps on specified residential street segments. Segments to be identified as part of ACHD's Pavement Management Program. Project funded all or in part through House Bill 312 funding. In-house design.

Programmed Expenditures			Project Costs	
Construction	\$2,929,000	2018	ACHD Share	\$3,358,000
Construction	\$154,000	2019	Plus Funding	\$0
Const Engineering	\$275,000	2018	Plus PriorCosts	
Programmed	\$3,358,000		Project Total	\$3,358,000

Residential Capital Maintenance (2019) - HB312 Project
Ada County / Boise / Kuna / Meridian / Eagle / Garden City / Star

Priority: of
 Adjusted Benefit/Cost Ratio:

GIS # Prj # ITD Key #
 Est Source Proj Mgr

North End, Boise – Various Segments
East End, Boise – Various Segments

Pavement rehabilitation and upgrade of adjacent pedestrian ramps on specified residential street segments. Segments to be identified as part of ACHD's Pavement Management Program. In-house design. Project funded all or in part through House Bill 312 funding.

Programmed Expenditures			Project Costs	
Prof Services - DSN	\$0	2018	ACHD Share	\$908,000
Construction	\$908,000	2019	Plus Funding	\$0
Programmed	\$908,000		Plus PriorCosts	
			Project Total	\$908,000

Residential Capital Maintenance (2020) - HB312 Project
Ada County / Boise / Kuna / Meridian / Eagle / Garden City / Star

Priority: of
 Adjusted Benefit/Cost Ratio:

GIS # Prj # ITD Key #
 Est Source Proj Mgr

Specific road segments to be determined.

Pavement rehabilitation and upgrade of adjacent pedestrian ramps on specified residential street segments. Segments to be identified as part of ACHD's Pavement Management Program. Project funded all or in part through House Bill 312 funding.

Programmed Expenditures			Project Costs	
Prof Services - DSN	\$40,000	2018	ACHD Share	\$3,135,000
Construction	\$3,095,000	2020	Plus Funding	\$0
Programmed	\$3,135,000		Plus PriorCosts	
			Project Total	\$3,135,000

Residential Capital Maintenance (2021) - HB312 Project
Ada County / Boise / Kuna / Meridian / Eagle / Garden City / Star

Priority: of
 Adjusted Benefit/Cost Ratio:

GIS # Prj # ITD Key #
 Est Source Proj Mgr

Specific road segments to be determined.

Pavement rehabilitation and upgrade of adjacent pedestrian ramps on specified residential street segments. Segments to be identified as part of ACHD's Pavement Management Program. Project funded all or in part through House Bill 312 funding. In-house design.

Programmed Expenditures			Project Costs	
Prof Services - DSN	\$50,000	2019	ACHD Share	\$5,166,000
Construction	\$5,116,000	2021	Plus Funding	\$0
Programmed	\$5,166,000		Plus PriorCosts	
			Project Total	\$5,166,000

Residential Capital Maintenance (2022) - HB312 Project
Ada County / Boise / Kuna / Meridian / Eagle / Garden City / Star

Priority: of
 Adjusted Benefit/Cost Ratio:

GIS # Prj # ITD Key #
 Est Source Proj Mgr

Specific road segments to be determined.

Pavement rehabilitation and upgrade of adjacent pedestrian ramps on specified residential street segments. Segments to be identified as part of ACHD's Pavement Management Program. Project funded all or in part through House Bill 312 funding.

Programmed Expenditures			Project Costs	
Prof Services - DSN	\$557,000	2020	ACHD Share	\$5,625,000
Construction	\$5,068,000	2022	Plus Funding	\$0
Programmed	\$5,625,000		Plus PriorCosts	
			Project Total	\$5,625,000

Residential Capital Maintenance (2023) - HB312 Project
Ada County / Boise / Kuna / Meridian / Eagle / Garden City / Star

Priority: of
 Adjusted Benefit/Cost Ratio:

GIS # Prj # ITD Key #
 Est Source Proj Mgr

Specific road segments to be determined.

Pavement rehabilitation and upgrade of adjacent pedestrian ramps on specified residential street segments. Segments to be identified as part of ACHD's Pavement Management Program. Project funded all or in part through House Bill 312 funding.

Programmed Expenditures			Project Costs	
Prof Services - DSN	\$597,000	2021	ACHD Share	\$6,100,000
Construction	\$5,503,000	PD	Plus Funding	\$0
Programmed	\$6,100,000		Plus PriorCosts	
			Project Total	\$6,100,000

Residential Capital Maintenance (2024) - HB312 Project
Ada County / Boise / Kuna / Meridian / Eagle / Garden City / Star

Priority: of
 Adjusted Benefit/Cost Ratio:

GIS # Prj # ITD Key #
 Est Source Proj Mgr

Specific road segments to be determined.

Pavement rehabilitation and upgrade of adjacent pedestrian ramps on specified residential street segments. Segments to be identified as part of ACHD's Pavement Management Program. Project funded all or in part through House Bill 312 funding.

Programmed Expenditures			Project Costs	
Prof Services - DSN	\$597,000	2022	ACHD Share	\$6,100,000
Construction	\$5,503,000	PD	Plus Funding	\$0
Programmed	\$6,100,000		Plus PriorCosts	
			Project Total	\$6,100,000

State St Rehabilitation, 16th St / 01st St - HB312 Project Boise

Priority: of
Adjusted Benefit/Cost Ratio:

GIS # Prj # ITD Key #
 Est Source Proj Mgr

Rehabilitate State St between 16th St and 01st St as part of the Downtown Boise Implementation Plan. Project funded all or in part through House Bill 312 funding.

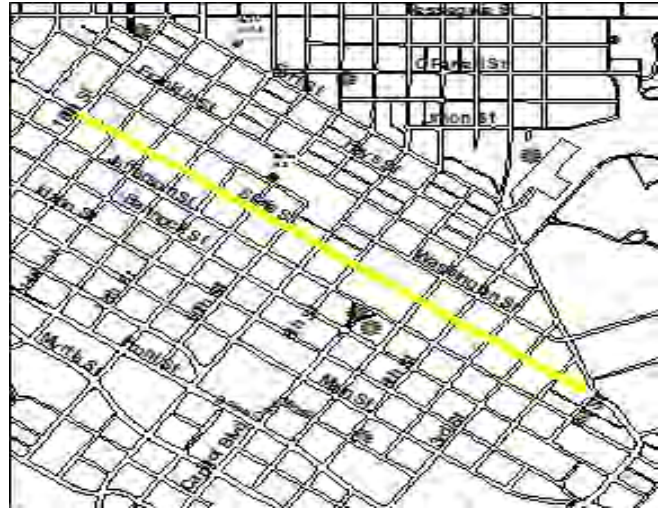

Programmed Expenditures			Project Costs	
Prof Services - DSN	\$165,000	2019	ACHD Share	\$940,000
Construction	\$750,000	2020	Plus Funding	\$0
Const Engineering	\$25,000	2020	Plus PriorCosts	
Programmed	\$940,000		Project Total	\$940,000