

Capital Maintenance Program

05th St and 06th St, Myrtle St / Fort St, Maintenance and Two-Way Conversion - HB312 Project Boise

Priority: _____ of _____
Adjusted 2015 Benefit/Cost Ratio: _____

GIS # Prj # ITD Key #
Est Source Proj Mgr

Perform road rehabilitation and 2-way conversion of 05th St and 06th St in downtown Boise. Concept design, to be completed in 2017, will evaluate the two-way conversion to determine its ultimate configuration. Project funded all or in part through House Bill 312 funding.

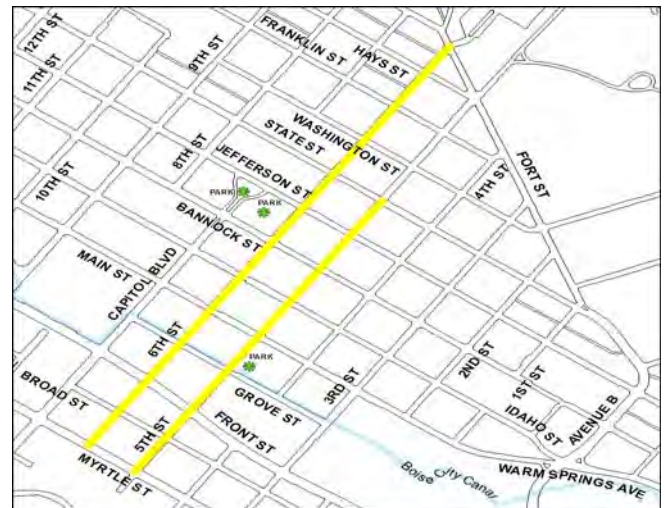

| Programmed Expenditures | | | Project Costs | |
|-------------------------|--------------------|------|-----------------|-------------|
| Construction | \$1,744,000 | 2019 | ACHD Share | \$2,050,000 |
| Const Engineering | \$56,000 | 2019 | Plus Funding | \$0 |
| Traffic Materials | \$250,000 | 2019 | Plus PriorCosts | |
| Programmed | \$2,050,000 | | Project Total | \$2,050,000 |

Arterial & Collector Capital Maintenance (2016) - HB312 Project

Priority: _____ of _____
Adjusted 2015 Benefit/Cost Ratio: _____

GIS # Prj # ITD Key #
Est Source Proj Mgr

Pavement rehabilitation and upgrade of adjacent pedestrian ramps on identified arterial and collector road segments as part of ACHD's Pavement Management Program. Construction began in FY2016. Project funded all or in part through House Bill 312 funding.

Amity Rd, Five Mile/Maple Grove
Cole Rd, Lake Hazel/Desert
Five Mile Rd, Foxbrush/Lake Hazel
Trestlewood Ave, Five Mile/Misty Glen
Valley Heights Dr, Hidden Valley Rim/Lake Hazel

| Programmed Expenditures | | | Project Costs | |
|-------------------------|------------------|------|-----------------|-----------|
| Construction | \$235,000 | 2017 | ACHD Share | \$235,000 |
| Programmed | \$235,000 | | Plus Funding | \$0 |
| | | | Plus PriorCosts | |
| | | | Project Total | \$235,000 |

Arterial & Collector Capital Maintenance (2017) - HB312 Project

Priority: _____ of _____
Adjusted 2015 Benefit/Cost Ratio: _____

GIS # Prj # ITD Key #
Est Source Proj Mgr

Pavement rehabilitation and upgrade of adjacent pedestrian ramps on identified arterial and collector road segments as part of ACHD's Pavement Management Program. Project funded all or in part through House Bill 312 funding.

Columbia Rd, Locust Grove Rd / Eagle Rd
Ballantyne Ln, Floating Feather Rd / Beacon Light Rd
Ranch Dr, Eagle Rd / Eagle Hills Way
Park Blvd, Broadway Ave / Walnut St
Franklin St, Maple Ave / Coston St
McKinley St, Ave D / Maple Ave
Haines St, Franklin St / Shenandoah Dr

| Programmed Expenditures | | | Project Costs | |
|-------------------------|--------------------|------|-----------------|-------------|
| Construction | \$1,600,000 | 2017 | ACHD Share | \$1,605,000 |
| Const Engineering | \$5,000 | 2017 | Plus Funding | \$0 |
| Programmed | \$1,605,000 | | Plus PriorCosts | |
| | | | Project Total | \$1,605,000 |

Arterial & Collector Capital Maintenance (2018) - HB312 Project

Priority: _____ of _____
Adjusted 2015 Benefit/Cost Ratio: _____

GIS # Prj # ITD Key #
Est Source Proj Mgr

**Black Cat Rd, Kuna Rd / Lake Hazel Rd
Black Cat Rd, Amity Rd / Victory Rd
Ten Mile Rd, Deer Flat Rd / Lake Hazel Rd**

Pavement rehabilitation and upgrade of adjacent pedestrian ramps on identified arterial and collector road segments as part of ACHD's Pavement Management Program. Project funded all or in part through House Bill 312 funding. In-house design.

| Programmed Expenditures | | | Project Costs | |
|-------------------------|--------------------|------|-----------------|-------------|
| Prof Services - DSN | \$15,000 | 2017 | ACHD Share | \$1,823,000 |
| Construction | \$1,808,000 | 2018 | Plus Funding | \$0 |
| Programmed | \$1,823,000 | | Plus PriorCosts | |
| | | | Project Total | \$1,823,000 |

Arterial & Collector Capital Maintenance (2019) - HB312 Project

Priority: _____ of _____
Adjusted 2015 Benefit/Cost Ratio: _____

GIS # Prj # ITD Key #
Est Source Proj Mgr

Specific road segments to be determined.

Pavement rehabilitation and upgrade of adjacent pedestrian ramps on identified arterial and collector road segments as part of ACHD's Pavement Management Program. Project funded all or in part through House Bill 312 funding.

| Programmed Expenditures | | | Project Costs | |
|-------------------------|------------------|------|-----------------|-----------|
| Prof Services - DSN | \$125,000 | 2018 | ACHD Share | \$777,000 |
| Construction | \$652,000 | 2019 | Plus Funding | \$0 |
| Programmed | \$777,000 | | Plus PriorCosts | |
| | | | Project Total | \$777,000 |

Arterial & Collector Capital Maintenance (2020) - HB312 Project

Priority: _____ of _____
Adjusted 2015 Benefit/Cost Ratio: _____

GIS # Prj # ITD Key #
Est Source Proj Mgr

Specific road segments to be determined.

Pavement rehabilitation and upgrade of adjacent pedestrian ramps on identified arterial and collector road segments as part of ACHD's Pavement Management Program. Project funded all or in part through House Bill 312 funding.

| Programmed Expenditures | | | Project Costs | |
|-------------------------|--------------------|------|-----------------|-------------|
| Prof Services - DSN | \$209,000 | 2019 | ACHD Share | \$2,109,000 |
| Construction | \$1,900,000 | 2020 | Plus Funding | \$0 |
| Programmed | \$2,109,000 | | Plus PriorCosts | |
| | | | Project Total | \$2,109,000 |

Arterial & Collector Capital Maintenance (2021) - HB312 Project

Priority: _____ of _____
Adjusted 2015 Benefit/Cost Ratio: _____

GIS # Prj # ITD Key #
Est Source Proj Mgr

Specific road segments to be determined.

Pavement rehabilitation and upgrade of adjacent pedestrian ramps on identified arterial and collector road segments as part of ACHD's Pavement Management Program. Project funded all or in part through House Bill 312 funding.

| Programmed Expenditures | | | Project Costs | |
|-------------------------|--------------------|------|-----------------|-------------|
| Prof Services - DSN | \$330,000 | 2020 | ACHD Share | \$3,333,000 |
| Construction | \$3,003,000 | 2021 | Plus Funding | \$0 |
| Programmed | \$3,333,000 | | Plus PriorCosts | |
| | | | Project Total | \$3,333,000 |

Arterial & Collector Capital Maintenance (2022) - HB312 Project

Priority: _____ of _____
Adjusted 2015 Benefit/Cost Ratio: _____

GIS # Prj # ITD Key #
Est Source Proj Mgr

Specific road segments to be determined.

Pavement rehabilitation and upgrade of adjacent pedestrian ramps on identified arterial and collector road segments as part of ACHD's Pavement Management Program. Project funded all or in part through House Bill 312 funding.

| Programmed Expenditures | | | Project Costs | |
|-------------------------|--------------------|------|-----------------|-------------|
| Prof Services - DSN | \$373,000 | 2021 | ACHD Share | \$3,768,000 |
| Construction | \$3,395,000 | PD | Plus Funding | \$0 |
| Programmed | \$3,768,000 | | Plus PriorCosts | |
| | | | Project Total | \$3,768,000 |

Arterial & Collector Capital Maintenance (2023) - HB312 Project

Priority: _____ of _____
Adjusted 2015 Benefit/Cost Ratio: _____

GIS # Prj # ITD Key #
Est Source Proj Mgr

Specific road segments to be determined.

Pavement rehabilitation and upgrade of adjacent pedestrian ramps on identified arterial and collector road segments as part of ACHD's Pavement Management Program. Project funded all or in part through House Bill 312 funding.

| Programmed Expenditures | | | Project Costs | |
|-------------------------|--------------------|----|-----------------|-------------|
| Prof Services - DSN | \$412,000 | PD | ACHD Share | \$4,165,000 |
| Construction | \$3,753,000 | PD | Plus Funding | \$0 |
| Programmed | \$4,165,000 | | Plus PriorCosts | |
| | | | Project Total | \$4,165,000 |

Bogus Basin Road Safety, Maintenance, and Trail Head

Priority: of ****TIP****
Adjusted 2015 Benefit/Cost Ratio:

GIS # Prj # ITD Key #
Est Source Proj Mgr

Federal aid project to rehabilitate and enhance safety to Bogus Basin Rd from milepost 9 to milepost 16.2, including roadway maintenance, concrete curbing, guardrail/barrier extensions/replacements, additional signage, improving drainage, improvements to 4 existing pullouts and construction of a new trailhead. Project to be completed in partnership with the Boise National Forest (BNF).



| Programmed Expenditures | | | Project Costs | |
|-------------------------|--------------------|------|----------------------|--------------------|
| Prof Services - DSN | \$420,000 | 2017 | ACHD Share | \$315,000 |
| Construction | \$4,756,000 | 2018 | Plus Funding | \$5,096,000 |
| Const Engineering | \$200,000 | 2018 | Plus PriorCosts | |
| Programmed | \$5,376,000 | | Project Total | \$5,411,000 |

Cul-de-Sac (2017) - HB312 Project

Priority: of
Adjusted 2015 Benefit/Cost Ratio:

GIS # Prj # ITD Key #
Est Source Proj Mgr

Rehabilitate cul-de-sacs in Maintenance Zone 6 as part of ACHD's Pavement Management Program. Project funded all or in part through House Bill 312 funding.



| Programmed Expenditures | | | Project Costs | |
|-------------------------|------------------|------|----------------------|------------------|
| Construction | \$475,000 | 2017 | ACHD Share | \$500,000 |
| Construction | \$25,000 | 2018 | Plus Funding | \$0 |
| Programmed | \$500,000 | | Plus PriorCosts | |
| | | | Project Total | \$500,000 |

Cul-de-Sac (2018) - HB312 Project

Priority: of
Adjusted 2015 Benefit/Cost Ratio:

GIS # Prj # ITD Key #
Est Source Proj Mgr

Rehabilitate cul-de-sacs in Maintenance Zone 1 as part of ACHD's Pavement Management Program. Project funded all or in part through House Bill 312 funding.



| Programmed Expenditures | | | Project Costs | |
|-------------------------|------------------|------|----------------------|------------------|
| Construction | \$300,000 | 2018 | ACHD Share | \$300,000 |
| Programmed | \$300,000 | | Plus Funding | \$0 |
| | | | Plus PriorCosts | |
| | | | Project Total | \$300,000 |

Cul-de-Sac (2019) - HB312 Project

Priority: of
Adjusted 2015 Benefit/Cost Ratio:

GIS # Prj # ITD Key #

Est Source Proj Mgr

Rehabilitate cul-de-sacs in Maintenance Zone 2 as part of ACHD's Pavement Management Program. Project funded all or in part through House Bill 312 funding.

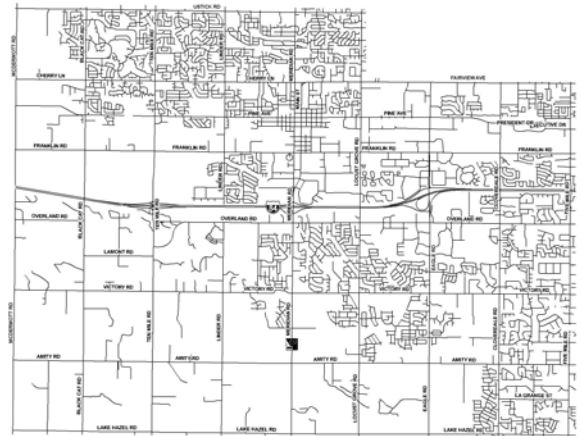

| Programmed Expenditures | | | Project Costs | |
|-------------------------|------------------|------|-----------------|-----------|
| Construction | \$300,000 | 2019 | ACHD Share | \$300,000 |
| Programmed | \$300,000 | | Plus Funding | \$0 |
| | | | Plus PriorCosts | |
| | | | Project Total | \$300,000 |

Cul-de-Sac (2020) - HB312 Project

Priority: of
Adjusted 2015 Benefit/Cost Ratio:

GIS # Prj # ITD Key #

Est Source Proj Mgr

Rehabilitate cul-de-sacs in Maintenance Zone 3 as part of ACHD's Pavement Management Program. Project funded all or in part through House Bill 312 funding.



| Programmed Expenditures | | | Project Costs | |
|-------------------------|------------------|------|-----------------|-----------|
| Construction | \$400,000 | 2020 | ACHD Share | \$400,000 |
| Programmed | \$400,000 | | Plus Funding | \$0 |
| | | | Plus PriorCosts | |
| | | | Project Total | \$400,000 |

Cul-de-Sac (2021) - HB312 Project

Priority: of
Adjusted 2015 Benefit/Cost Ratio:

GIS # Prj # ITD Key #

Est Source Proj Mgr

Rehabilitate cul-de-sacs in Maintenance Zone 4 as part of ACHD's Pavement Management Program. Project funded all or in part through House Bill 312 funding.

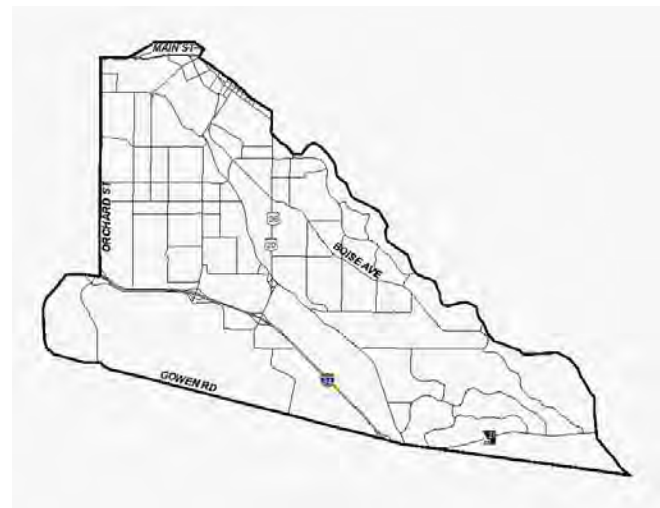

| Programmed Expenditures | | | Project Costs | |
|-------------------------|------------------|------|-----------------|-----------|
| Construction | \$400,000 | 2021 | ACHD Share | \$400,000 |
| Programmed | \$400,000 | | Plus Funding | \$0 |
| | | | Plus PriorCosts | |
| | | | Project Total | \$400,000 |

Cul-de-Sac (2022) - HB312 Project

Priority: _____ of _____
Adjusted 2015 Benefit/Cost Ratio: _____

GIS # Prj # ITD Key #
Est Source Proj Mgr

Rehabilitate cul-de-sacs in Maintenance Zone 5 as part of ACHD's Pavement Management Program. Project funded all or in part through House Bill 312 funding.

| Programmed Expenditures | | | Project Costs | |
|-------------------------|------------------|----|-----------------|-----------|
| Construction | \$400,000 | PD | ACHD Share | \$400,000 |
| Programmed | \$400,000 | | Plus Funding | \$0 |
| | | | Plus PriorCosts | |
| | | | Project Total | \$400,000 |



Cul-de-Sac (2023) - HB312 Project

Priority: _____ of _____
Adjusted 2015 Benefit/Cost Ratio: _____

GIS # Prj # ITD Key #
Est Source Proj Mgr

Rehabilitate cul-de-sacs in Maintenance Zone 6 as part of ACHD's Pavement Management Program. Project funded all or in part through House Bill 312 funding.

| Programmed Expenditures | | | Project Costs | |
|-------------------------|------------------|----|-----------------|-----------|
| Construction | \$400,000 | PD | ACHD Share | \$400,000 |
| Programmed | \$400,000 | | Plus Funding | \$0 |
| | | | Plus PriorCosts | |
| | | | Project Total | \$400,000 |



**Downtown Boise Implementation (2016) - HB312 Project
Boise**

Priority: _____ of _____
Adjusted 2015 Benefit/Cost Ratio: _____

GIS # Prj # ITD Key #
Est Source Proj Mgr

Perform road rehabilitation and 2-way conversion of select streets in downtown Boise in concert with CCDC and other projects in accordance with the Downtown Boise Implementation Plan. Construction began in FY2016. The primary focus of FY2017 work is Broad St. Project funded all or in part through House Bill 312 funding. Project includes GIS #SM216-01, SM216-02, and SM216-03.

| Programmed Expenditures | | | Project Costs | |
|-------------------------|------------------|------|-----------------|-----------|
| Construction | \$502,000 | 2017 | ACHD Share | \$502,000 |
| Programmed | \$502,000 | | Plus Funding | \$0 |
| | | | Plus PriorCosts | |
| | | | Project Total | \$502,000 |

Broad St, Capitol Blvd / 2nd St

**Downtown Boise Implementation (2017) - HB312 Project
Boise**

Priority: of
Adjusted 2015 Benefit/Cost Ratio:

GIS # Prj # ITD Key #
Est Source Proj Mgr

**3rd St, Myrtle St / State St
11th St, Myrtle St / Front St
11th St, Main St / Bannock St
13th St, Front St / Main St**

Perform road rehabilitation and 2-way conversion of select streets in downtown Boise in concert with CCDC and other projects in accordance with the Downtown Boise Implementation Plan. The primary focus in 2017 will be maintenance of 3rd St. Project funded all or in part through House Bill 312 funding.

| Programmed Expenditures | | | Project Costs | |
|-------------------------|--------------------|------|-----------------|-------------|
| Prof Services - DSN | \$93,000 | 2017 | ACHD Share | \$2,943,000 |
| Construction | \$2,590,000 | 2017 | Plus Funding | \$0 |
| Construction | \$250,000 | 2018 | Plus PriorCosts | |
| Const Engineering | \$10,000 | 2017 | Project Total | \$2,943,000 |
| Programmed | \$2,943,000 | | | |

**Downtown Boise Implementation (2018) - HB312 Project
Boise**

Priority: of
Adjusted 2015 Benefit/Cost Ratio:

GIS # Prj # ITD Key #
Est Source Proj Mgr

**2nd St, Myrtle St / Front St
4th St, S/O Myrtle St / Broad St
4th St, Grove St / State St
8th St, Myrtle St / Broad St
Ave A, Myrtle St / Front St
Broad St, 9th St / 8th St
Front St, 16th St / 13th St
Grove St, 6th St / 3rd St
Idaho St, 16th St / Broadway Ave
Main St, 10th St / Broadway Ave
River St, 9th St / Capitol Blvd**

Perform road rehabilitation of select streets in downtown Boise in concert with CCDC and other projects in accordance with the Downtown Boise Implementation Plan. The primary focus of 2018 will be maintenance on Main St and Idaho St. Project funded all or in part through House Bill 312 funding.

| Programmed Expenditures | | | Project Costs | |
|-------------------------|--------------------|------|-----------------|-------------|
| Prof Services - DSN | \$250,000 | 2017 | ACHD Share | \$2,609,000 |
| Construction | \$2,300,000 | 2018 | Plus Funding | \$0 |
| Const Engineering | \$54,000 | 2018 | Plus PriorCosts | |
| Utilities | \$5,000 | 2017 | Project Total | \$2,609,000 |
| Programmed | \$2,609,000 | | | |

**Downtown Boise Implementation (2019) - HB312 Project
Boise**

Priority: of
Adjusted 2015 Benefit/Cost Ratio:

GIS # Prj # ITD Key #
Est Source Proj Mgr

Specific road segments to be determined.

Perform road rehabilitation of select streets in downtown Boise in concert with CCDC and other projects in accordance with the Downtown Boise Implementation Plan. Project includes installation of an accessible pedestrian signal at 8th St and Bannock St. Project funded all or in part through House Bill 312 funding.

| Programmed Expenditures | | | Project Costs | |
|-------------------------|--------------------|------|-----------------|-------------|
| Prof Services - DSN | \$456,000 | 2018 | ACHD Share | \$1,947,000 |
| Construction | \$1,420,000 | 2019 | Plus Funding | \$0 |
| Const Engineering | \$56,000 | 2019 | Plus PriorCosts | |
| Traffic Materials | \$15,000 | 2019 | Project Total | \$1,947,000 |
| Programmed | \$1,947,000 | | | |

**Downtown Boise Implementation (2020) - HB312 Project
Boise**

Priority: of
Adjusted 2015 Benefit/Cost Ratio:

GIS # Prj # ITD Key #
Est Source Proj Mgr

Specific road segments to be determined.

Perform road rehabilitation of select streets in downtown Boise in concert with CCDC and other projects in accordance with the Downtown Boise Implementation Plan. Project funded all or in part through House Bill 312 funding.

| Programmed Expenditures | | | Project Costs | |
|-------------------------|--------------------|------|----------------------|--------------------|
| Prof Services - DSN | \$442,000 | 2019 | ACHD Share | \$2,520,000 |
| Construction | \$2,030,000 | 2020 | Plus Funding | \$0 |
| Const Engineering | \$48,000 | 2020 | Plus PriorCosts | |
| Programmed | \$2,520,000 | | Project Total | \$2,520,000 |

Federal Aid Capital Maintenance (2016)

Priority: of ****TIP****
Adjusted 2015 Benefit/Cost Ratio:

GIS # Prj # ITD Key #
Est Source Proj Mgr

Pavement rehabilitation and upgrade of adjacent pedestrian ramps on Capitol Blvd, Rose Hill St / Yale Ln. Actual construction will occur in 2017 due to construction conflicts with the Broadway Bridge rebuild by ITD in 2016. Projects selected as part of ACHD's Pavement Management Program.

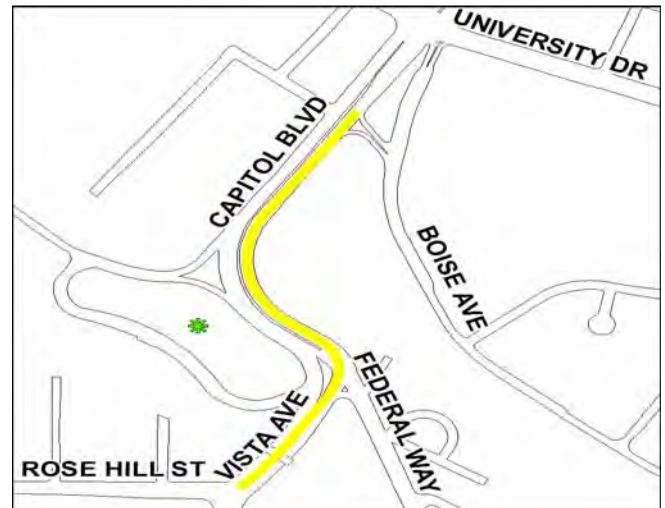

| Programmed Expenditures | | | Project Costs | |
|-------------------------|-----------------|------|----------------------|-----------------|
| Const Engineering | \$25,000 | 2017 | ACHD Share | \$2,000 |
| Programmed | \$25,000 | | Plus Funding | \$23,000 |
| | | | Plus PriorCosts | \$45,000 |
| | | | Project Total | \$70,000 |

Federal Aid Capital Maintenance (2017)

Priority: of ****TIP****
Adjusted 2015 Benefit/Cost Ratio:

GIS # Prj # ITD Key #
Est Source Proj Mgr

Pavement rehabilitation and upgrade of adjacent pedestrian ramps on identified arterial and collector road segments. Projects selected as part of ACHD's Pavement Management Program.

- 3rd St, Myrtle St / Front St
- 3rd St, Jefferson St / Fort St
- 4th St, State St / Washington St
- 11th St, Main St / Bannock St
- 11th St, Myrtle St / Front St
- Amity Rd, Production St / Market St
- Cherry Ln, Ten Mile Rd / Meridian Rd
- Collister Dr, Hill Rd / Quail Ridge Dr
- Curtis Rd, Morris Hill Rd / I-84
- Harrison Blvd, Hays St / Hill Rd
- Irene St, 33rd St / Harrison Blvd
- River Run Dr, Parkcenter Blvd / Parkcenter Blvd
- Rose Hill St, Roosevelt St / Vista Ave
- Seaman Gulch Rd, Hill Rd Pkwy / Landfill Entrance
- Sycamore Dr, State St / Taft St
- Taft St, 32nd St / 28th St
- Warm Springs Ave, Starcrest Dr / Starview Dr
- Warm Springs Ave, Eckert Rd / Hwy 21

| Programmed Expenditures | | | Project Costs | |
|-------------------------|------------------|------|----------------------|--------------------|
| Prof Services - DSN | \$200,000 | 2017 | ACHD Share | \$658,000 |
| Construction | \$398,000 | 2017 | Plus Funding | \$5,801,000 |
| Const Engineering | \$285,000 | 2017 | Plus PriorCosts | |
| Const Engineering | \$15,000 | 2018 | Project Total | \$6,459,000 |
| Programmed | \$898,000 | | | |

Federal Aid Capital Maintenance (2019) - Local

Priority: of ****TIP****
Adjusted 2015 Benefit/Cost Ratio:

GIS # Prj # ITD Key #
Est Source Proj Mgr

**Annett St, Victory Rd / Targee St
Cherry Ln, Shoshone St / Broxon St**

Pavement rehabilitation and upgrade of adjacent pedestrian ramps on identified arterial and collector road segments. Projects selected as part of ACHD's Pavement Management Program.

| Programmed Expenditures | | | Project Costs | |
|-------------------------|------------------|------|-----------------|-----------|
| Prof Services - DSN | \$20,000 | 2017 | ACHD Share | \$320,000 |
| Construction | \$300,000 | 2019 | Plus Funding | \$0 |
| Programmed | \$320,000 | | Plus PriorCosts | |
| | | | Project Total | \$320,000 |

Federal Aid Capital Maintenance (2019) - Phase 1

Priority: of ****TIP****
Adjusted 2015 Benefit/Cost Ratio:

GIS # Prj # ITD Key #
Est Source Proj Mgr

**Amity Rd, Enterprise St / Production St
Boise Ave, Leadville Ave / Gekeler Ln
Columbus St, Targee St / Overland Rd
Division Ave, Boise Ave / Beacon St
Elder St, Owyhee St / Vista Ave
Enterprise St, Amity Rd / Commerce Ave
Fairview Ave, Locust Grove Rd / Cloverdale Rd
Latah St, Overland Rd / Alpine St
Linden St, Broadway Ave / Gekeler Ln
Owyhee St, Elder St / Cherry Ln
Roosevelt St, Overland Rd / Emerald St
Surprise Way, Amity Rd / Hwy 21
Orchard St, Overland Rd / UPRR Crossing**

Pavement rehabilitation and upgrade of adjacent pedestrian ramps on identified arterial and collector road segments. Projects selected as part of ACHD's Pavement Management Program.

| Programmed Expenditures | | | Project Costs | |
|-------------------------|------------------|------|-----------------|-------------|
| Prof Services - DSN | \$403,000 | 2017 | ACHD Share | \$406,000 |
| Prof Services - DSN | \$100,000 | 2018 | Plus Funding | \$5,128,000 |
| Construction | \$336,000 | 2019 | Plus PriorCosts | |
| Const Engineering | \$34,000 | 2019 | Project Total | \$5,534,000 |
| Programmed | \$873,000 | | | |

Federal Aid Capital Maintenance (2019) - Phase 2

Priority: of ****TIP****
Adjusted 2015 Benefit/Cost Ratio:

GIS # Prj # ITD Key #
Est Source Proj Mgr

**Gowen Rd, Orchard St / Broadway Ave
Gowen Rd, Business Way / I-84
Pleasant Valley Rd, Hollilynn Dr / Gowen Rd**

Pavement rehabilitation and upgrade of adjacent pedestrian ramps on identified arterial and collector road segments. Projects selected as part of ACHD's Pavement Management Program.

| Programmed Expenditures | | | Project Costs | |
|-------------------------|------------------|------|-----------------|-------------|
| Prof Services - DSN | \$200,000 | 2017 | ACHD Share | \$174,000 |
| Prof Services - DSN | \$27,000 | 2018 | Plus Funding | \$2,209,000 |
| Construction | \$144,000 | 2019 | Plus PriorCosts | |
| Const Engineering | \$14,000 | 2019 | Project Total | \$2,383,000 |
| Programmed | \$385,000 | | | |

Federal Aid Capital Maintenance (2020) - Local

Priority: of ****TIP****
Adjusted 2015 Benefit/Cost Ratio:

GIS # Prj # ITD Key #
Est Source Proj Mgr

Specific road segments to be determined.

Pavement rehabilitation and upgrade of adjacent pedestrian ramps on identified arterial and collector road segments. Projects selected as part of ACHD's Pavement Management Program.

| Programmed Expenditures | | | Project Costs | |
|-------------------------|------------------|------|-----------------|-----------|
| Prof Services - DSN | \$20,000 | 2018 | ACHD Share | \$320,000 |
| Construction | \$300,000 | 2020 | Plus Funding | \$0 |
| Programmed | \$320,000 | | Plus PriorCosts | |
| | | | Project Total | \$320,000 |

Federal Aid Capital Maintenance (2020) - Phase 1

Priority: of ****TIP****
Adjusted 2015 Benefit/Cost Ratio:

GIS # Prj # ITD Key #
Est Source Proj Mgr

Specific road segments to be determined.

Pavement rehabilitation and upgrade of adjacent pedestrian ramps on identified arterial and collector road segments. Projects selected as part of ACHD's Pavement Management Program.

| Programmed Expenditures | | | Project Costs | |
|-------------------------|------------------|------|-----------------|-------------|
| Prof Services - DSN | \$515,000 | 2018 | ACHD Share | \$417,000 |
| Construction | \$345,000 | 2020 | Plus Funding | \$5,601,000 |
| Const Engineering | \$34,000 | 2020 | Plus PriorCosts | |
| Programmed | \$894,000 | | Project Total | \$6,018,000 |

Federal Aid Capital Maintenance (2020) - Phase 2

Priority: of ****TIP****
Adjusted 2015 Benefit/Cost Ratio:

GIS # Prj # ITD Key #
Est Source Proj Mgr

Specific road segments to be determined.

Pavement rehabilitation and upgrade of adjacent pedestrian ramps on identified arterial and collector road segments. Projects selected as part of ACHD's Pavement Management Program.

| Programmed Expenditures | | | Project Costs | |
|-------------------------|------------------|------|-----------------|-------------|
| Prof Services - DSN | \$222,000 | 2018 | ACHD Share | \$179,000 |
| Construction | \$148,000 | 2020 | Plus Funding | \$2,254,000 |
| Const Engineering | \$15,000 | 2020 | Plus PriorCosts | |
| Programmed | \$385,000 | | Project Total | \$2,433,000 |

Federal Aid Capital Maintenance (2021) - Local

Priority: of ****TIP****
Adjusted 2015 Benefit/Cost Ratio:

GIS # Prj # ITD Key #
Est Source Proj Mgr

Specific road segments to be determined.

Pavement rehabilitation and upgrade of adjacent pedestrian ramps on identified arterial and collector road segments. Projects selected as part of ACHD's Pavement Management Program.

| Programmed Expenditures | | | Project Costs | |
|-------------------------|------------------|------|-----------------|-----------|
| Prof Services - DSN | \$20,000 | 2019 | ACHD Share | \$320,000 |
| Construction | \$300,000 | 2021 | Plus Funding | \$0 |
| Programmed | \$320,000 | | Plus PriorCosts | |
| | | | Project Total | \$320,000 |

Federal Aid Capital Maintenance (2021) - Phase 1

Priority: of ****TIP****
Adjusted 2015 Benefit/Cost Ratio:

GIS # Prj # ITD Key #
Est Source Proj Mgr

Specific road segments to be determined.

Pavement rehabilitation and upgrade of adjacent pedestrian ramps on identified arterial and collector road segments. Projects selected as part of ACHD's Pavement Management Program.

| Programmed Expenditures | | | Project Costs | |
|-------------------------|------------------|------|-----------------|-------------|
| Prof Services - DSN | \$503,000 | 2019 | ACHD Share | \$407,000 |
| Construction | \$336,000 | 2021 | Plus Funding | \$5,138,000 |
| Const Engineering | \$34,000 | 2021 | Plus PriorCosts | |
| Programmed | \$873,000 | | Project Total | \$5,545,000 |

Federal Aid Capital Maintenance (2021) - Phase 2

Priority: of ****TIP****
Adjusted 2015 Benefit/Cost Ratio:

GIS # Prj # ITD Key #
Est Source Proj Mgr

Specific road segments to be determined.

Pavement rehabilitation and upgrade of adjacent pedestrian ramps on identified arterial and collector road segments. Projects selected as part of ACHD's Pavement Management Program.

| Programmed Expenditures | | | Project Costs | |
|-------------------------|------------------|------|-----------------|-------------|
| Prof Services - DSN | \$217,000 | 2019 | ACHD Share | \$173,000 |
| Construction | \$144,000 | 2021 | Plus Funding | \$2,205,000 |
| Const Engineering | \$14,000 | 2021 | Plus PriorCosts | |
| Programmed | \$375,000 | | Project Total | \$2,378,000 |

Federal Aid Capital Maintenance (2022) - Local

Priority: of ****TIP****
Adjusted 2015 Benefit/Cost Ratio:

GIS # Prj # ITD Key #
Est Source Proj Mgr

Specific road segments to be determined.

Pavement rehabilitation and upgrade of adjacent pedestrian ramps on identified arterial and collector road segments. Projects selected as part of ACHD's Pavement Management Program.

| Programmed Expenditures | | | Project Costs | |
|-------------------------|------------------|------|-----------------|-----------|
| Prof Services - DSN | \$20,000 | 2020 | ACHD Share | \$320,000 |
| Construction | \$300,000 | PD | Plus Funding | \$0 |
| Programmed | \$320,000 | | Plus PriorCosts | |
| | | | Project Total | \$320,000 |

Federal Aid Capital Maintenance (2022) - Phase 1

Priority: of ****TIP****
Adjusted 2015 Benefit/Cost Ratio:

GIS # Prj # ITD Key #
Est Source Proj Mgr

Specific road segments to be determined.

Pavement rehabilitation and upgrade of adjacent pedestrian ramps on identified arterial and collector road segments. Projects selected as part of ACHD's Pavement Management Program.

| Programmed Expenditures | | | Project Costs | |
|-------------------------|------------------|------|-----------------|-------------|
| Prof Services - DSN | \$504,000 | 2020 | ACHD Share | \$408,000 |
| Construction | \$337,000 | PD | Plus Funding | \$5,144,000 |
| Const Engineering | \$34,000 | PD | Plus PriorCosts | |
| Programmed | \$875,000 | | Project Total | \$5,552,000 |

Federal Aid Capital Maintenance (2022) - Phase 2

Priority: of ****TIP****
Adjusted 2015 Benefit/Cost Ratio:

GIS # Prj # ITD Key #
Est Source Proj Mgr

Specific road segments to be determined.

Pavement rehabilitation and upgrade of adjacent pedestrian ramps on identified arterial and collector road segments. Projects selected as part of ACHD's Pavement Management Program.

| Programmed Expenditures | | | Project Costs | |
|-------------------------|------------------|------|-----------------|-------------|
| Prof Services - DSN | \$217,000 | 2020 | ACHD Share | \$173,000 |
| Construction | \$144,000 | PD | Plus Funding | \$2,207,000 |
| Const Engineering | \$14,000 | PD | Plus PriorCosts | |
| Programmed | \$375,000 | | Project Total | \$2,380,000 |

Federal Aid Capital Maintenance (2023) - Local

Priority: of ****TIP****
Adjusted 2015 Benefit/Cost Ratio:

GIS # Prj # ITD Key #

Est Source Proj Mgr

Specific road segments to be determined.

Pavement rehabilitation and upgrade of adjacent pedestrian ramps on identified arterial and collector road segments. Projects selected as part of ACHD's Pavement Management Program.

| Programmed Expenditures | | | Project Costs | |
|-------------------------|------------------|------|-----------------|-----------|
| Prof Services - DSN | \$20,000 | 2021 | ACHD Share | \$320,000 |
| Construction | \$300,000 | PD | Plus Funding | \$0 |
| Programmed | \$320,000 | | Plus PriorCosts | |
| | | | Project Total | \$320,000 |

Federal Aid Capital Maintenance (2023) - Phase 1

Priority: of ****TIP****
Adjusted 2015 Benefit/Cost Ratio:

GIS # Prj # ITD Key #

Est Source Proj Mgr

Specific road segments to be determined.

Pavement rehabilitation and upgrade of adjacent pedestrian ramps on identified arterial and collector road segments. Projects selected as part of ACHD's Pavement Management Program.

| Programmed Expenditures | | | Project Costs | |
|-------------------------|------------------|------|-----------------|-------------|
| Prof Services - DSN | \$504,000 | 2021 | ACHD Share | \$408,000 |
| Construction | \$337,000 | PD | Plus Funding | \$5,144,000 |
| Const Engineering | \$34,000 | PD | Plus PriorCosts | |
| Programmed | \$875,000 | | Project Total | \$5,552,000 |

Federal Aid Capital Maintenance (2023) - Phase 2

Priority: of ****TIP****
Adjusted 2015 Benefit/Cost Ratio:

GIS # Prj # ITD Key #

Est Source Proj Mgr

Specific road segments to be determined.

Pavement rehabilitation and upgrade of adjacent pedestrian ramps on identified arterial and collector road segments. Projects selected as part of ACHD's Pavement Management Program.

| Programmed Expenditures | | | Project Costs | |
|-------------------------|------------------|------|-----------------|-------------|
| Prof Services - DSN | \$217,000 | 2021 | ACHD Share | \$173,000 |
| Construction | \$144,000 | PD | Plus Funding | \$2,207,000 |
| Const Engineering | \$14,000 | PD | Plus PriorCosts | |
| Programmed | \$375,000 | | Project Total | \$2,380,000 |

Kuna Downtown Revitalization, Phase 1 - HB312 Project
Kuna

Priority: of ****TIP****
 Adjusted 2015 Benefit/Cost Ratio:

GIS # Prj # ITD Key #
 Est Source Proj Mgr

Complete roadway maintenance on Main St, between Avenue A and Avenue C in coordination with the City of Kuna's Downtown Revitalization project. The City of Kuna will design, bid, and construct improvements. Project costs reflect only ACHD's contribution to the overall project. Project funded all or in part through House Bill 312 funding.



| Programmed Expenditures | | | Project Costs | |
|-------------------------|------------------|------|-----------------|-----------|
| Construction | \$200,000 | 2017 | ACHD Share | \$200,000 |
| Programmed | \$200,000 | | Plus Funding | \$0 |
| | | | Plus PriorCosts | |
| | | | Project Total | \$200,000 |

Kuna-Mora Rd Rehabilitation, Pleasant Valley Rd / I-84 - HB312 Project
Ada County

Priority: of
 Adjusted 2015 Benefit/Cost Ratio:

GIS # Prj # ITD Key #
 Est Source Proj Mgr

Rehabilitate Kuna-Mora Rd between Pleasant Valley Rd and I-84 as part of ACHD's Pavement Management Program. Project funded all or in part through House Bill 312 funding. In-house design.

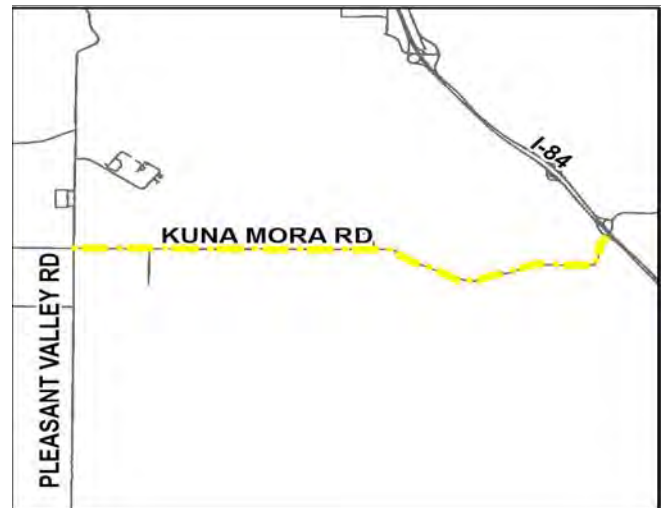

| Programmed Expenditures | | | Project Costs | |
|-------------------------|--------------------|------|-----------------|-------------|
| RW Acquisition | \$3,000 | 2017 | ACHD Share | \$2,546,000 |
| Construction | \$2,543,000 | 2019 | Plus Funding | \$0 |
| Programmed | \$2,546,000 | | Plus PriorCosts | |
| | | | Project Total | \$2,546,000 |

Lake Hazel Rd Reclaim, Five Mile Rd / Maple Grove Rd - HB312 Project
Ada County

Priority: of
 Adjusted 2015 Benefit/Cost Ratio:

GIS # Prj # ITD Key #
 Est Source Proj Mgr

Rehabilitate Lake Hazel Rd between Five Mile Rd and Maple Grove Rd as part of ACHD's Pavement Management Program. Project to include shoulder widening. Project funded all or in part through House Bill 312 funding. In-house design with minimal consultant services.

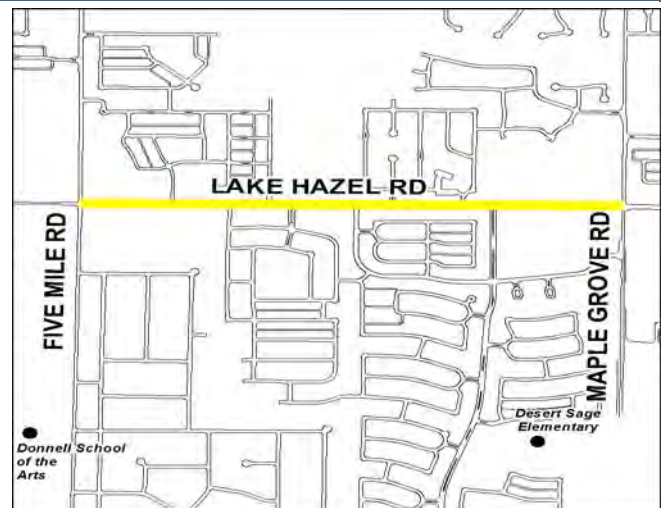

| Programmed Expenditures | | | Project Costs | |
|-------------------------|------------------|------|-----------------|-----------|
| Construction | \$850,000 | 2017 | ACHD Share | \$850,000 |
| Programmed | \$850,000 | | Plus Funding | \$0 |
| | | | Plus PriorCosts | |
| | | | Project Total | \$850,000 |

Maintenance Crack Seal (2017) - HB312 Project

Priority: of
Adjusted 2015 Benefit/Cost Ratio:

GIS # Prj # ITD Key #
Est Source Proj Mgr

Seal cracks in arterial and collector roadways in Preventative Maintenance Zone 6 as part of ACHD's Pavement Management Program. Project funded all or in part through House Bill 312 funding.

| Programmed Expenditures | | | Project Costs | |
|-------------------------|------------------|------|-----------------|-----------|
| Construction | \$450,000 | 2017 | ACHD Share | \$450,000 |
| Programmed | \$450,000 | | Plus Funding | \$0 |
| | | | Plus PriorCosts | |
| | | | Project Total | \$450,000 |



Maintenance Crack Seal (2018) - HB312 Project

Priority: of
Adjusted 2015 Benefit/Cost Ratio:

GIS # Prj # ITD Key #
Est Source Proj Mgr

Seal cracks in arterial and collector roadways in Preventative Maintenance Zone 1 as part of ACHD's Pavement Management Program. Project funded all or in part through House Bill 312 funding.

| Programmed Expenditures | | | Project Costs | |
|-------------------------|------------------|------|-----------------|-----------|
| Construction | \$450,000 | 2018 | ACHD Share | \$450,000 |
| Programmed | \$450,000 | | Plus Funding | \$0 |
| | | | Plus PriorCosts | |
| | | | Project Total | \$450,000 |



Maintenance Crack Seal (2019) - HB312 Project

Priority: of
Adjusted 2015 Benefit/Cost Ratio:

GIS # Prj # ITD Key #
Est Source Proj Mgr

Seal cracks in arterial and collector roadways in Preventative Maintenance Zone 2 as part of ACHD's Pavement Management Program. Project funded all or in part through House Bill 312 funding.

| Programmed Expenditures | | | Project Costs | |
|-------------------------|------------------|------|-----------------|-----------|
| Construction | \$325,000 | 2019 | ACHD Share | \$325,000 |
| Programmed | \$325,000 | | Plus Funding | \$0 |
| | | | Plus PriorCosts | |
| | | | Project Total | \$325,000 |

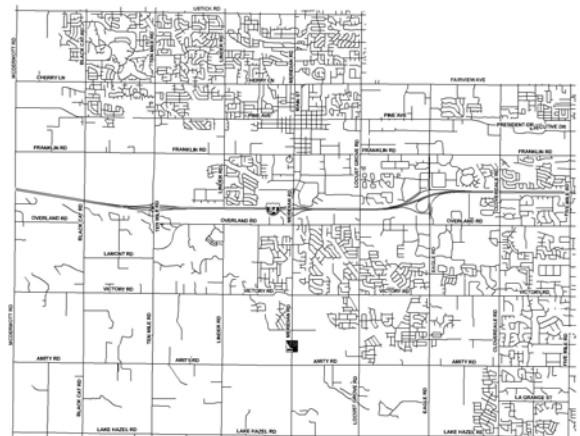

Maintenance Crack Seal (2020) - HB312 Project

Priority: of
Adjusted 2015 Benefit/Cost Ratio:

GIS # Prj # ITD Key #
Est Source Other Proj Mgr

Seal cracks in arterial and collector roadways in Preventative Maintenance Zone 3 as part of ACHD's Pavement Management Program. Project funded all or in part through House Bill 312 funding.

| Programmed Expenditures | | | Project Costs | |
|-------------------------|------------------|------|-----------------|-----------|
| Construction | \$325,000 | 2020 | ACHD Share | \$325,000 |
| Programmed | \$325,000 | | Plus Funding | \$0 |
| | | | Plus PriorCosts | |
| | | | Project Total | \$325,000 |

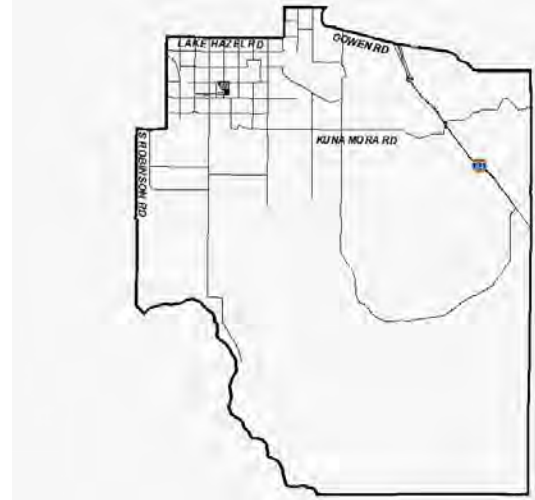

Maintenance Crack Seal (2021) - HB312 Project

Priority: of
Adjusted 2015 Benefit/Cost Ratio:

GIS # Prj # ITD Key #
Est Source Other Proj Mgr

Seal cracks in arterial and collector roadways in Preventative Maintenance Zone 4 as part of ACHD's Pavement Management Program. Project funded all or in part through House Bill 312 funding.

| Programmed Expenditures | | | Project Costs | |
|-------------------------|------------------|------|-----------------|-----------|
| Construction | \$325,000 | 2021 | ACHD Share | \$325,000 |
| Programmed | \$325,000 | | Plus Funding | \$0 |
| | | | Plus PriorCosts | |
| | | | Project Total | \$325,000 |



Maintenance Crack Seal (2022) - HB312 Project

Priority: of
Adjusted 2015 Benefit/Cost Ratio:

GIS # Prj # ITD Key #
Est Source Other Proj Mgr

Seal cracks in arterial and collector roadways in Preventative Maintenance Zone 5 as part of ACHD's Pavement Management Program. Project funded all or in part through House Bill 312 funding.

| Programmed Expenditures | | | Project Costs | |
|-------------------------|------------------|----|-----------------|-----------|
| Construction | \$325,000 | PD | ACHD Share | \$325,000 |
| Programmed | \$325,000 | | Plus Funding | \$0 |
| | | | Plus PriorCosts | |
| | | | Project Total | \$325,000 |



Maintenance Crack Seal (2023) - HB312 Project

Priority: _____ of _____
Adjusted 2015 Benefit/Cost Ratio: _____

GIS # Prj # ITD Key #
Est Source Proj Mgr

Seal cracks in arterial and collector roadways in Preventative Maintenance Zone 6 as part of ACHD's Pavement Management Program. Project funded all or in part through House Bill 312 funding.

| Programmed Expenditures | | | Project Costs | |
|-------------------------|------------------|----|-----------------|-----------|
| Construction | \$325,000 | PD | ACHD Share | \$325,000 |
| Programmed | \$325,000 | | Plus Funding | \$0 |
| | | | Plus PriorCosts | |
| | | | Project Total | \$325,000 |



Microseal (2017) - HB312 Project

Priority: _____ of _____
Adjusted 2015 Benefit/Cost Ratio: _____

GIS # Prj # ITD Key #
Est Source Proj Mgr

Microseal roadways as part of ACHD's Pavement Management Program. Project funded all or in part through House Bill 312 funding.

Main St, Central Dr / Fairview Ave (Meridian)

| Programmed Expenditures | | | Project Costs | |
|-------------------------|------------------|------|-----------------|-----------|
| Construction | \$250,000 | 2017 | ACHD Share | \$250,000 |
| Programmed | \$250,000 | | Plus Funding | \$0 |
| | | | Plus PriorCosts | |
| | | | Project Total | \$250,000 |

Microseal (2018) - HB312 Project

Priority: _____ of _____
Adjusted 2015 Benefit/Cost Ratio: _____

GIS # Prj # ITD Key #
Est Source Proj Mgr

Microseal roadways as part of ACHD's Pavement Management Program. Project funded all or in part through House Bill 312 funding.

Specific road segments to be determined.

| Programmed Expenditures | | | Project Costs | |
|-------------------------|------------------|------|-----------------|-----------|
| Construction | \$250,000 | 2018 | ACHD Share | \$250,000 |
| Programmed | \$250,000 | | Plus Funding | \$0 |
| | | | Plus PriorCosts | |
| | | | Project Total | \$250,000 |

Microseal (2019) - HB312 ProjectPriority: _____ of _____
Adjusted 2015 Benefit/Cost Ratio: _____GIS # Prj # ITD Key # Est Source Proj Mgr **Specific road segments to be determined.**

Microseal roadways as part of ACHD's Pavement Management Program. Project funded all or in part through House Bill 312 funding.

| Programmed Expenditures | | | Project Costs | |
|-------------------------|------------------|------|-----------------|-----------|
| Construction | \$250,000 | 2019 | ACHD Share | \$250,000 |
| Programmed | \$250,000 | | Plus Funding | \$0 |
| | | | Plus PriorCosts | |
| | | | Project Total | \$250,000 |

Microseal (2020) - HB312 ProjectPriority: _____ of _____
Adjusted 2015 Benefit/Cost Ratio: _____GIS # Prj # ITD Key # Est Source Proj Mgr **Specific road segments to be determined.**

Microseal roadways as part of ACHD's Pavement Management Program. Project funded all or in part through House Bill 312 funding.

| Programmed Expenditures | | | Project Costs | |
|-------------------------|------------------|------|-----------------|-----------|
| Construction | \$400,000 | 2020 | ACHD Share | \$400,000 |
| Programmed | \$400,000 | | Plus Funding | \$0 |
| | | | Plus PriorCosts | |
| | | | Project Total | \$400,000 |

Microseal (2021) - HB312 ProjectPriority: _____ of _____
Adjusted 2015 Benefit/Cost Ratio: _____GIS # Prj # ITD Key # Est Source Proj Mgr **Specific road segments to be determined.**

Microseal roadways as part of ACHD's Pavement Management Program. Project funded all or in part through House Bill 312 funding.

| Programmed Expenditures | | | Project Costs | |
|-------------------------|------------------|------|-----------------|-----------|
| Construction | \$400,000 | 2021 | ACHD Share | \$400,000 |
| Programmed | \$400,000 | | Plus Funding | \$0 |
| | | | Plus PriorCosts | |
| | | | Project Total | \$400,000 |

Microseal (2022) - HB312 ProjectPriority: _____ of _____
Adjusted 2015 Benefit/Cost Ratio: _____GIS # Prj # ITD Key # Est Source Proj Mgr **Specific road segments to be determined.**

Microseal roadways as part of ACHD's Pavement Management Program. Project funded all or in part through House Bill 312 funding.

| Programmed Expenditures | | | Project Costs | |
|-------------------------|------------------|----|-----------------|-----------|
| Construction | \$400,000 | PD | ACHD Share | \$400,000 |
| Programmed | \$400,000 | | Plus Funding | \$0 |
| | | | Plus PriorCosts | |
| | | | Project Total | \$400,000 |

Microseal (2023) - HB312 ProjectPriority: _____ of _____
Adjusted 2015 Benefit/Cost Ratio: _____GIS # Prj # ITD Key # Est Source Proj Mgr **Specific road segments to be determined.**

Microseal roadways as part of ACHD's Pavement Management Program. Project funded all or in part through House Bill 312 funding.

| Programmed Expenditures | | | Project Costs | |
|-------------------------|------------------|----|-----------------|-----------|
| Construction | \$400,000 | PD | ACHD Share | \$400,000 |
| Programmed | \$400,000 | | Plus Funding | \$0 |
| | | | Plus PriorCosts | |
| | | | Project Total | \$400,000 |

**Residential Capital Maintenance (2017) - HB312 Project
Ada County / Boise / Kuna / Meridian / Eagle / Garden City / Star**Priority: _____ of _____
Adjusted 2015 Benefit/Cost Ratio: _____GIS # Prj # ITD Key # Est Source Proj Mgr **Amyx Jay Subdivision, Boise
William Harris Subdivision, Boise
Eagleson Park No. 4 Subdivision, Boise
Sorenson No. 3 Subdivision, Boise
Southwestern Subdivision, Boise
Fox Meadow Subdivision, Boise
Butler Sunview Estates, Kuna**

Pavement rehabilitation and upgrade of adjacent pedestrian ramps on specified residential street segments. Segments to be identified as part of ACHD's Pavement Management Program. Project funded all or in part through House Bill 312 funding.

| Programmed Expenditures | | | Project Costs | |
|-------------------------|--------------------|------|-----------------|-------------|
| Construction | \$1,800,000 | 2017 | ACHD Share | \$2,000,000 |
| Construction | \$200,000 | 2018 | Plus Funding | \$0 |
| Programmed | \$2,000,000 | | Plus PriorCosts | |
| | | | Project Total | \$2,000,000 |

Residential Capital Maintenance (2018) - HB312 Project
Ada County / Boise / Kuna / Meridian / Eagle / Garden City / Star

Priority: _____ of _____
 Adjusted 2015 Benefit/Cost Ratio: _____

GIS # Prj # ITD Key #
 Est Source Proj Mgr

North End, Boise – Various Segments
East End, Boise – Various Segments

Pavement rehabilitation and upgrade of adjacent pedestrian ramps on specified residential street segments. Segments to be identified as part of ACHD's Pavement Management Program. Project funded all or in part through House Bill 312 funding. In-house design.

| Programmed Expenditures | | | Project Costs | |
|-------------------------|--------------------|------|-----------------|-------------|
| Prof Services - DSN | \$8,000 | 2017 | ACHD Share | \$3,091,000 |
| Construction | \$3,083,000 | 2018 | Plus Funding | \$0 |
| Programmed | \$3,091,000 | | Plus PriorCosts | |
| | | | Project Total | \$3,091,000 |

Residential Capital Maintenance (2019) - HB312 Project
Ada County / Boise / Kuna / Meridian / Eagle / Garden City / Star

Priority: _____ of _____
 Adjusted 2015 Benefit/Cost Ratio: _____

GIS # Prj # ITD Key #
 Est Source Proj Mgr

Specific road segments to be determined.

Pavement rehabilitation and upgrade of adjacent pedestrian ramps on specified residential street segments. Segments to be identified as part of ACHD's Pavement Management Program. Project funded all or in part through House Bill 312 funding.

| Programmed Expenditures | | | Project Costs | |
|-------------------------|--------------------|------|-----------------|-------------|
| Prof Services - DSN | \$330,000 | 2018 | ACHD Share | \$1,238,000 |
| Construction | \$908,000 | 2019 | Plus Funding | \$0 |
| Programmed | \$1,238,000 | | Plus PriorCosts | |
| | | | Project Total | \$1,238,000 |

Residential Capital Maintenance (2020) - HB312 Project
Ada County / Boise / Kuna / Meridian / Eagle / Garden City / Star

Priority: _____ of _____
 Adjusted 2015 Benefit/Cost Ratio: _____

GIS # Prj # ITD Key #
 Est Source Proj Mgr

Specific road segments to be determined.

Pavement rehabilitation and upgrade of adjacent pedestrian ramps on specified residential street segments. Segments to be identified as part of ACHD's Pavement Management Program. Project funded all or in part through House Bill 312 funding.

| Programmed Expenditures | | | Project Costs | |
|-------------------------|--------------------|------|-----------------|-------------|
| Prof Services - DSN | \$326,000 | 2019 | ACHD Share | \$3,290,000 |
| Construction | \$2,964,000 | 2020 | Plus Funding | \$0 |
| Programmed | \$3,290,000 | | Plus PriorCosts | |
| | | | Project Total | \$3,290,000 |

Residential Capital Maintenance (2021) - HB312 Project
Ada County / Boise / Kuna / Meridian / Eagle / Garden City / Star

Priority: _____ of _____
 Adjusted 2015 Benefit/Cost Ratio: _____

GIS # Prj # ITD Key #

Est Source Proj Mgr

Specific road segments to be determined.

Pavement rehabilitation and upgrade of adjacent pedestrian ramps on specified residential street segments. Segments to be identified as part of ACHD's Pavement Management Program. Project funded all or in part through House Bill 312 funding.

| Programmed Expenditures | | | Project Costs | |
|-------------------------|--------------------|------|-----------------|-------------|
| Prof Services - DSN | \$563,000 | 2020 | ACHD Share | \$5,679,000 |
| Construction | \$5,116,000 | 2021 | Plus Funding | \$0 |
| Programmed | \$5,679,000 | | Plus PriorCosts | |
| | | | Project Total | \$5,679,000 |

Residential Capital Maintenance (2022) - HB312 Project
Ada County / Boise / Kuna / Meridian / Eagle / Garden City / Star

Priority: _____ of _____
 Adjusted 2015 Benefit/Cost Ratio: _____

GIS # Prj # ITD Key #

Est Source Proj Mgr

Specific road segments to be determined.

Pavement rehabilitation and upgrade of adjacent pedestrian ramps on specified residential street segments. Segments to be identified as part of ACHD's Pavement Management Program. Project funded all or in part through House Bill 312 funding.

| Programmed Expenditures | | | Project Costs | |
|-------------------------|--------------------|------|-----------------|-------------|
| Prof Services - DSN | \$557,000 | 2021 | ACHD Share | \$5,625,000 |
| Construction | \$5,068,000 | PD | Plus Funding | \$0 |
| Programmed | \$5,625,000 | | Plus PriorCosts | |
| | | | Project Total | \$5,625,000 |

Residential Capital Maintenance (2023) - HB312 Project
Ada County / Boise / Kuna / Meridian / Eagle / Garden City / Star

Priority: _____ of _____
 Adjusted 2015 Benefit/Cost Ratio: _____

GIS # Prj # ITD Key #

Est Source Proj Mgr

Specific road segments to be determined.

Pavement rehabilitation and upgrade of adjacent pedestrian ramps on specified residential street segments. Segments to be identified as part of ACHD's Pavement Management Program. Project funded all or in part through House Bill 312 funding.

| Programmed Expenditures | | | Project Costs | |
|-------------------------|--------------------|----|-----------------|-------------|
| Prof Services - DSN | \$597,000 | PD | ACHD Share | \$6,100,000 |
| Construction | \$5,503,000 | PD | Plus Funding | \$0 |
| Programmed | \$6,100,000 | | Plus PriorCosts | |
| | | | Project Total | \$6,100,000 |

**State St Rehabilitation, 16th St / 01st St - HB312 Project
Boise**

Priority: _____ of _____
Adjusted 2015 Benefit/Cost Ratio: _____

GIS # Prj # ITD Key #

Est Source Proj Mgr

Rehabilitate State St between 16th St and 01st St as part of the Downtown Boise Implementation Plan. Project funded all or in part through House Bill 312 funding.



| Programmed Expenditures | | | Project Costs | |
|-------------------------|------------------|------|-----------------|-----------|
| Prof Services - DSN | \$165,000 | 2019 | ACHD Share | \$940,000 |
| Construction | \$750,000 | 2020 | Plus Funding | \$0 |
| Const Engineering | \$25,000 | 2020 | Plus PriorCosts | |
| Programmed | \$940,000 | | Project Total | \$940,000 |