

Bridge Program

Bridge Replacements

**04th St Bridge #1291, 200' W/O Kay St
Kuna**

Priority: _____ of _____
Adjusted 2015 Benefit/Cost Ratio: _____

GIS # Prj # ITD Key #
Est Source Engineer Proj Mgr

Replace bridge #1291 over the Teed Lateral on 04th Street as part of ACHD's Bridge Maintenance Program. Project includes addition of sidewalk on the north side of 04th St and a right turn lane on 04th St at Kay Ave.



Programmed Expenditures			Project Costs	
Construction	\$470,000	2017	ACHD Share	\$470,000
Programmed	\$470,000		Plus Funding	\$0
			Plus PriorCosts	
			Project Total	\$470,000

**34th St Bridge #1319, at Forsythia Dr
Boise**

Priority: _____ of _____
Adjusted 2015 Benefit/Cost Ratio: _____

GIS # Prj # ITD Key #
Est Source Proj Mgr

Replace bridge #1319 over Boise City Canal on 34th St as part of ACHD's Bridge Maintenance Program.



Programmed Expenditures			Project Costs	
Prof Services - DSN	\$52,000	2019	ACHD Share	\$287,000
Title Search - RW	\$1,000	2019	Plus Funding	\$0
Appraisals - RW	\$12,000	2019	Plus PriorCosts	
RW Acquisition	\$20,000	2019	Project Total	\$287,000
Construction	\$194,000	2020		
Const Engineering	\$5,000	2020		
Utilities	\$3,000	2020		
Programmed	\$287,000			

38th St Bridge #1440, 0.2 miles N/O Chinden Blvd
Garden City

Priority: _____ of _____
 Adjusted 2015 Benefit/Cost Ratio: _____

GIS # Prj # ITD Key #
 Est Source Proj Mgr

Replace bridge #1440 over the Thurman Mill Canal on 38th St as part of ACHD's Bridge Maintenance Program.



Programmed Expenditures			Project Costs	
Prof Services - DSN	\$29,000	2019	ACHD Share	\$130,000
Title Search - RW	\$1,000	2019	Plus Funding	\$0
Appraisals - RW	\$8,000	2019	Plus PriorCosts	
Construction	\$87,000	2020	Project Total	\$130,000
Const Engineering	\$3,000	2020		
Utilities	\$2,000	2020		
Programmed	\$130,000			

39th St Bridge #1439, 0.2 miles N/O Chinden Blvd
Garden City

Priority: _____ of _____
 Adjusted 2015 Benefit/Cost Ratio: _____

GIS # Prj # ITD Key #
 Est Source Proj Mgr

Replace bridge #1439 over the Thurman Mill Canal on 39th St as part of ACHD's Bridge Maintenance Program.

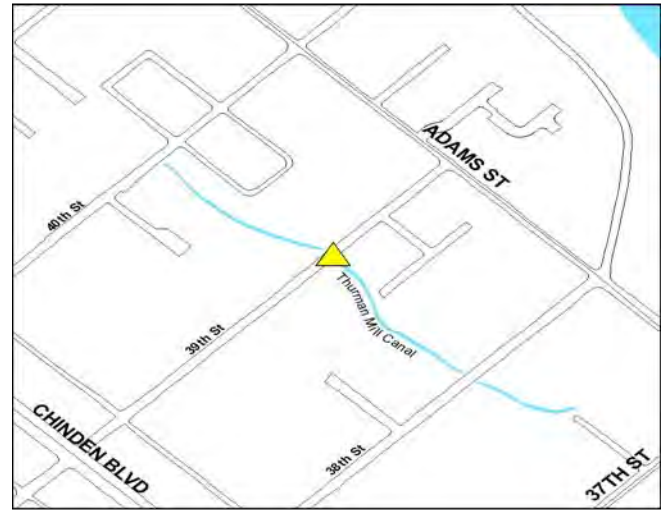

Programmed Expenditures			Project Costs	
Prof Services - DSN	\$50,000	2017	ACHD Share	\$186,800
Prof Services - DSN	\$5,000	2018	Plus Funding	\$0
Title Search - RW	\$1,000	2017	Plus PriorCosts	
RW Acquisition	\$1,000	2018	Project Total	\$186,800
Construction	\$130,000	2019		
Programmed	\$187,000			

41st St Bridge #1437, 600' N/O Chinden Blvd
Garden City

Priority: _____ of _____
 Adjusted 2015 Benefit/Cost Ratio: _____

GIS # Prj # ITD Key #
 Est Source Proj Mgr

Replace bridge #1437 over the Thurman Mill Canal on 41st St as part of ACHD's Bridge Maintenance Program. In-house design.



Programmed Expenditures			Project Costs	
Prof Services - DSN	\$23,000	2018	ACHD Share	\$138,000
Title Search - RW	\$1,000	2018	Plus Funding	\$0
RW Acquisition	\$33,000	2019	Plus PriorCosts	
Construction	\$73,000	2020	Project Total	\$138,000
Const Engineering	\$5,000	2020		
Utilities	\$3,000	2020		
Programmed	\$138,000			

43rd St Bridge #1434, 500' N/O Chinden Blvd
Garden City

Priority: _____ of _____
 Adjusted 2015 Benefit/Cost Ratio: _____

GIS # Prj # ITD Key #
 Est Source Proj Mgr

Replace bridge #1434 over the Thurman Mill Canal on 43rd Street as part of ACHD's Bridge Maintenance Program.

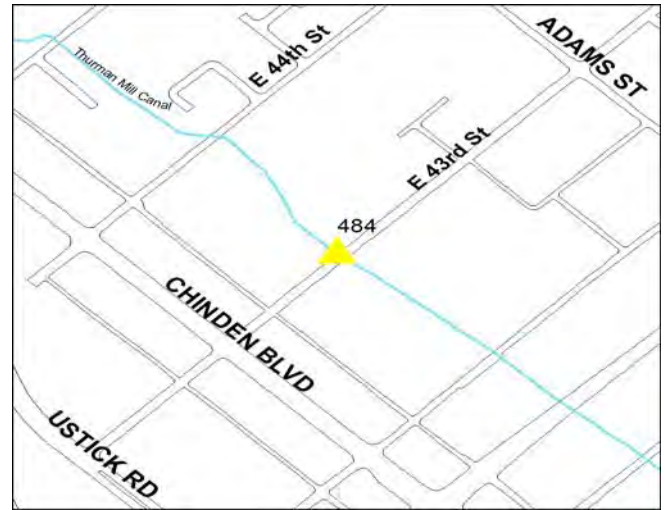

Programmed Expenditures			Project Costs	
Prof Services - DSN	\$50,000	2017	ACHD Share	\$180,600
Prof Services - DSN	\$5,000	2018	Plus Funding	\$0
Title Search - RW	\$1,000	2017	Plus PriorCosts	
RW Acquisition	\$1,000	2018	Project Total	\$180,600
Construction	\$124,000	2019		
Programmed	\$181,000			

44th St Bridge #1433, 0.1 miles N/O Chinden Blvd
Garden City

Priority: _____ of _____
 Adjusted 2015 Benefit/Cost Ratio: _____

GIS # Prj # ITD Key #
 Est Source Proj Mgr

Replace bridge #1433 over the Thurman Mill Canal on 44th St as part of ACHD's Bridge Maintenance Program.

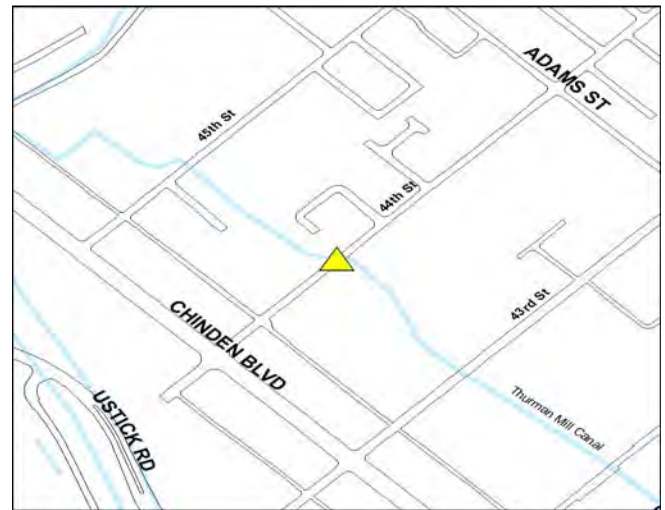

Programmed Expenditures			Project Costs	
Prof Services - DSN	\$50,000	2019	ACHD Share	\$217,000
Construction	\$167,000	2021	Plus Funding	\$0
Programmed	\$217,000		Plus PriorCosts	
			Project Total	\$217,000

45th St Bridge #1432, 500' N/O Chinden Blvd
Garden City

Priority: _____ of _____
 Adjusted 2015 Benefit/Cost Ratio: _____

GIS # Prj # ITD Key #
 Est Source Proj Mgr

Replace bridge #1432 over the Thurman Mill Canal on 45th St as part of ACHD's Bridge Maintenance Program.

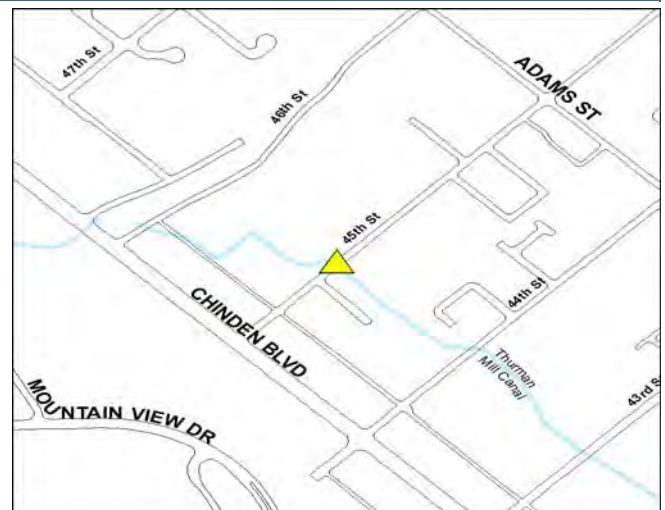

Programmed Expenditures			Project Costs	
Prof Services - DSN	\$50,000	2020	ACHD Share	\$217,000
Construction	\$167,000	PD	Plus Funding	\$0
Programmed	\$217,000		Plus PriorCosts	
			Project Total	\$217,000

**46th St Bridge #1452, 100' N/O Chinden Blvd
Garden City**

Priority: _____ of _____
Adjusted 2015 Benefit/Cost Ratio: _____

GIS # Prj # ITD Key #
Est Source Proj Mgr

Replace bridge #1452 over Thurman Mill Canal on 46th St as part of ACHD's Bridge Maintenance Program. Project to be constructed concurrently with Osage St Bridge #1451.

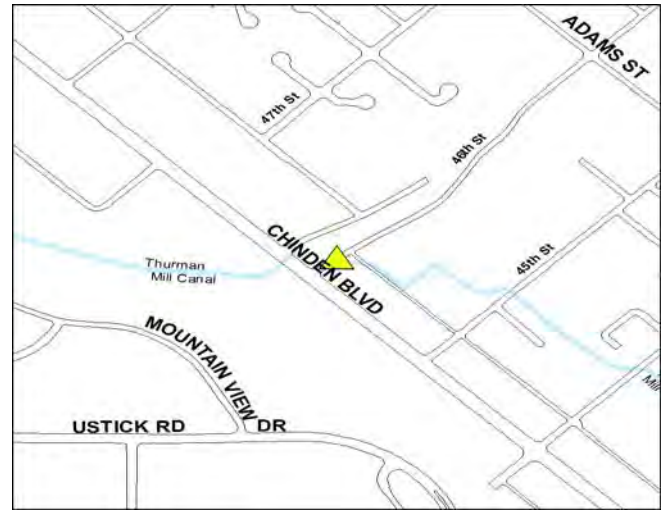

Programmed Expenditures			Project Costs	
Prof Services - DSN	\$46,000	2017	ACHD Share	\$216,000
Title Search - RW	\$1,000	2017	Plus Funding	\$0
RW Acquisition	\$3,000	2018	Plus PriorCosts	
Construction	\$161,000	2019	Project Total	\$216,000
Const Engineering	\$5,000	2019		
Programmed	\$216,000			

**Barber Dr Bridge #1335, 1.0 miles NW/O Warm Springs Blvd
Boise**

Priority: _____ of _____
Adjusted 2015 Benefit/Cost Ratio: _____

GIS # Prj # ITD Key #
Est Source Proj Mgr

Replace/widen bridge #1335 over Warm Springs Creek on Barber Dr as part of ACHD's Bridge Maintenance Program.



Programmed Expenditures			Project Costs	
Prof Services - DSN	\$115,000	2018	ACHD Share	\$596,500
Title Search - RW	\$1,000	2018	Plus Funding	\$0
Appraisals - RW	\$6,000	2018	Plus PriorCosts	
RW Acquisition	\$14,000	2018	Project Total	\$596,500
Construction	\$460,000	2019		
Utilities	\$1,000	2018		
Programmed	\$597,000			

**Black Cat Rd Bridge #1177, 1/3 mile S/O Amity Rd
Ada County**

Priority: _____ of _____
Adjusted 2015 Benefit/Cost Ratio: _____

GIS # Prj # ITD Key #
Est Source Proj Mgr

Replace bridge #1177 over Mason Creek on Black Cat Rd as part of ACHD's Bridge Maintenance Program. Project to be constructed concurrently with Black Cat Rd Bridge #1178.

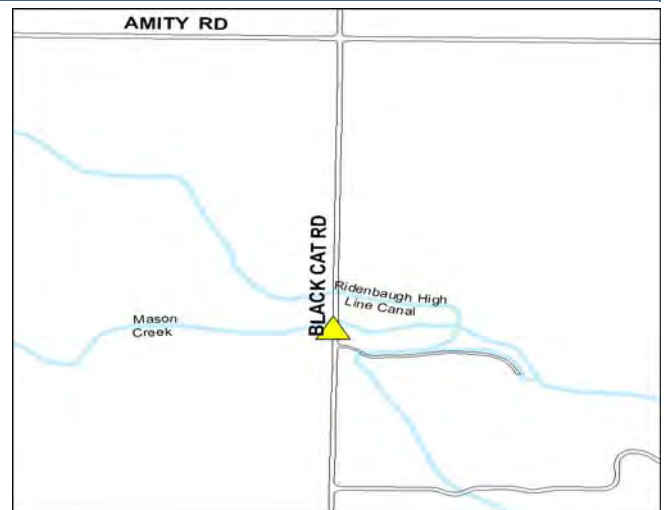

Programmed Expenditures			Project Costs	
Prof Services - DSN	\$245,000	PD	ACHD Share	\$1,226,000
Title Search - RW	\$2,000	PD	Plus Funding	\$0
RW Acquisition	\$55,000	PD	Plus PriorCosts	
Construction	\$895,000	UF	Project Total	\$1,226,000
Const Engineering	\$22,000	UF		
Utilities	\$7,000	UF		
Programmed	\$1,226,000			

Black Cat Rd Bridge #1178, 1/3 mile S/O Amity Rd

Ada County

Priority: of
Adjusted 2015 Benefit/Cost Ratio:

GIS # MI216-01 Prj # ITD Key #

Est Source Scoping 2014 Proj Mgr Kuperus

Replace bridge #1178 over Ridenbaugh Canal on Black Cat Rd as part of ACHD's Bridge Maintenance Program. Project to be constructed concurrently with Black Cat Rd Bridge #1177.

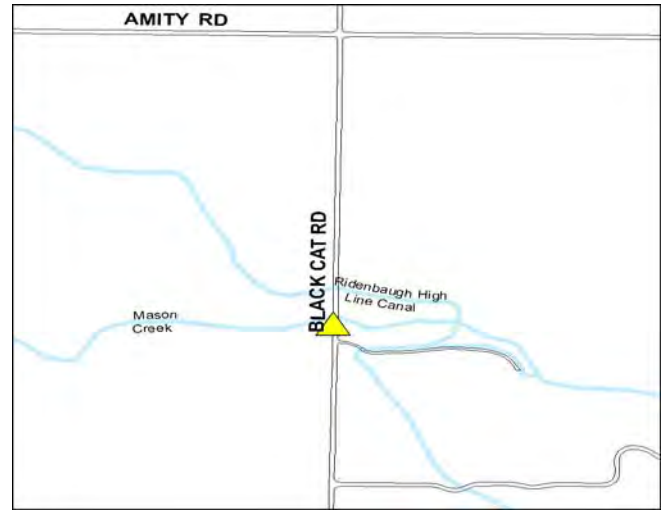

Programmed Expenditures			Project Costs	
Construction	\$875,000	UF	ACHD Share	\$875,000
Programmed	\$875,000		Plus Funding	\$0
			Plus PriorCosts	
			Project Total	\$875,000

**Breneman St Bridge #1418, 150' E/O 26th St
Boise**

Priority: of
Adjusted 2015 Benefit/Cost Ratio:

GIS # MI214-10 Prj # 216008 ITD Key #

Est Source Engineer Proj Mgr McCarthy

Replace bridge #1418 over Boise City Canal on Breneman St as part of ACHD's Bridge Maintenance Program. In-house design.



Programmed Expenditures			Project Costs	
RW Acquisition	\$5,000	2017	ACHD Share	\$85,000
Construction	\$80,000	2018	Plus Funding	\$0
Programmed	\$85,000		Plus PriorCosts	
			Project Total	\$85,000

**Bridge Preventative Maintenance (2017) - HB312
Ada County / Boise / Kuna / Meridian / Eagle / Garden City / Star**

Priority: of
Adjusted 2015 Benefit/Cost Ratio:

GIS # MI216-05 Prj # 217001 ITD Key #

Est Source Planning Proj Mgr Kuperus

Bridge deck overlay and sealing of specified bridges. Locations to be identified as part of ACHD's Bridge Maintenance Program.

- 9th St Bridge #2204
- Bogus Basin Rd Bridge #2146
- Gekeler Ln Bridge #2157

Programmed Expenditures			Project Costs	
Construction	\$100,000	2017	ACHD Share	\$100,000
Programmed	\$100,000		Plus Funding	\$0
			Plus PriorCosts	
			Project Total	\$100,000

Bridge Preventative Maintenance (2018)

Priority: of

Ada County / Boise / Kuna / Meridian / Eagle / Garden City / Star

Adjusted 2015 Benefit/Cost Ratio:

GIS # Prj # ITD Key # Est Source Proj Mgr

Bridge deck overlay and sealing of specified bridges. Locations to be identified as part of ACHD's Bridge Maintenance Program.

Programmed Expenditures			Project Costs	
Construction	\$100,000	2018	ACHD Share	\$100,000
Programmed	\$100,000		Plus Funding	\$0
			Plus PriorCosts	
			Project Total	\$100,000

Bridge Preventative Maintenance (2019)

Priority: of

Ada County / Boise / Kuna / Meridian / Eagle / Garden City / Star

Adjusted 2015 Benefit/Cost Ratio:

GIS # Prj # ITD Key # Est Source Proj Mgr

Bridge deck overlay and sealing of specified bridges. Locations to be identified as part of ACHD's Bridge Maintenance Program.

Programmed Expenditures			Project Costs	
Construction	\$150,000	2019	ACHD Share	\$150,000
Programmed	\$150,000		Plus Funding	\$0
			Plus PriorCosts	
			Project Total	\$150,000

Bridge Preventative Maintenance (2020)

Priority: of

Ada County / Boise / Kuna / Meridian / Eagle / Garden City / Star

Adjusted 2015 Benefit/Cost Ratio:

GIS # Prj # ITD Key # Est Source Proj Mgr

Bridge deck overlay and sealing of specified bridges. Locations to be identified as part of ACHD's Bridge Maintenance Program.

Programmed Expenditures			Project Costs	
Construction	\$150,000	2020	ACHD Share	\$150,000
Programmed	\$150,000		Plus Funding	\$0
			Plus PriorCosts	
			Project Total	\$150,000

Bridge Preventative Maintenance (2021)

Priority: of

Ada County / Boise / Kuna / Meridian / Eagle / Garden City / Star

Adjusted 2015 Benefit/Cost Ratio:

GIS # Prj # ITD Key # Est Source Proj Mgr

Bridge deck overlay and sealing of specified bridges. Locations to be identified as part of ACHD's Bridge Maintenance Program.

Programmed Expenditures			Project Costs	
Construction	\$150,000	2021	ACHD Share	\$150,000
Programmed	\$150,000		Plus Funding	\$0
			Plus PriorCosts	
			Project Total	\$150,000

Bridge Preventative Maintenance (2022)

Priority: of

Ada County / Boise / Kuna / Meridian / Eagle / Garden City / Star

Adjusted 2015 Benefit/Cost Ratio:

GIS # Prj # ITD Key # Est Source Proj Mgr

Bridge deck overlay and sealing of specified bridges. Locations to be identified as part of ACHD's Bridge Maintenance Program.

Programmed Expenditures			Project Costs	
Construction	\$150,000	PD	ACHD Share	\$150,000
Programmed	\$150,000		Plus Funding	\$0
			Plus PriorCosts	
			Project Total	\$150,000

Bridge Preventative Maintenance (2023)

Priority: of

Ada County / Boise / Kuna / Meridian / Eagle / Garden City / Star

Adjusted 2015 Benefit/Cost Ratio:

GIS # Prj # ITD Key # Est Source Proj Mgr

Bridge deck overlay and sealing of specified bridges. Locations to be identified as part of ACHD's Bridge Maintenance Program.

Programmed Expenditures			Project Costs	
Construction	\$150,000	PD	ACHD Share	\$150,000
Programmed	\$150,000		Plus Funding	\$0
			Plus PriorCosts	
			Project Total	\$150,000

**Cloverdale Rd Bridge #2104 and #2105, N/O Muir Ridge Dr
Boise**

Priority: _____ of _____
Adjusted 2015 Benefit/Cost Ratio: _____

GIS # Prj # ITD Key #
Est Source Proj Mgr

Realign Canal to the west side of Cloverdale Road and eliminate these two structures. Would require 1 new structure be built in coordination with the adjacent landowner and development. Project timing is dependent upon adjacent development.



Programmed Expenditures			Project Costs	
Prof Services - DSN	\$250,000	UF	ACHD Share	\$1,314,000
RW Acquisition	\$100,000	UF	Plus Funding	\$0
Construction	\$964,000	UF	Plus PriorCosts	
Programmed	\$1,314,000		Project Total	\$1,314,000

**Conover St Bridge #1449, 0.17 miles N/O State St
Eagle**

Priority: _____ of _____
Adjusted 2015 Benefit/Cost Ratio: _____

GIS # Prj # ITD Key #
Est Source Proj Mgr

Replace bridge #1449 over Spoils Bank Canal on Conover St as part of ACHD's Bridge Maintenance Program. In-house design.

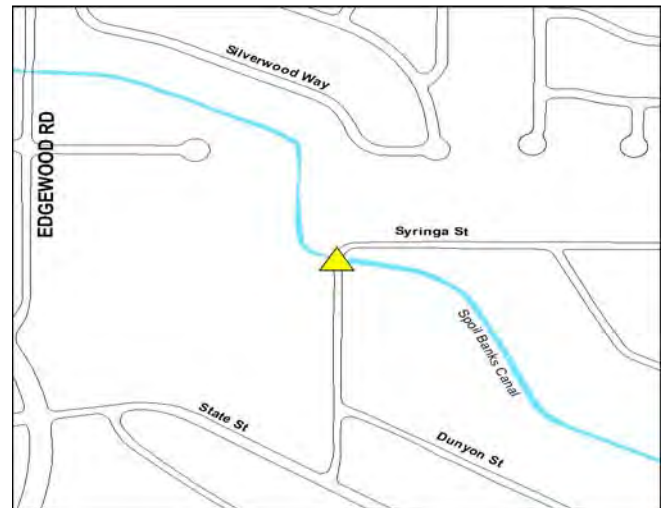

Programmed Expenditures			Project Costs	
Title Search - RW	\$2,000	2017	ACHD Share	\$314,600
Appraisals - RW	\$3,000	2018	Plus Funding	\$0
RW Acquisition	\$45,000	2018	Plus PriorCosts	
Construction	\$255,000	2019	Project Total	\$314,600
Const Engineering	\$8,000	2019		
Utilities	\$2,000	2017		
Programmed	\$315,000			

**Eagle Rd Bridge #1029, 1/4 mile N/O Floating Feather Rd
Eagle**

Priority: _____ of _____
Adjusted 2015 Benefit/Cost Ratio: _____

GIS # Prj # ITD Key #
Est Source Proj Mgr

Replace/widen bridge #1029 over Dry Creek on Eagle Rd as part of ACHD's Bridge Maintenance Program.



Programmed Expenditures			Project Costs	
RW Acquisition	\$13,000	2017	ACHD Share	\$875,500
Survey	\$25,000	2017	Plus Funding	\$0
Construction	\$545,000	2017	Plus PriorCosts	\$56,500
Construction	\$273,000	2018	Project Total	\$932,000
Const Engineering	\$20,000	2017		
Programmed	\$876,000			

Eagle Rd Bridge #1216, 1/2 mile N/O Amity Rd Meridian

Priority: _____ of _____
Adjusted 2015 Benefit/Cost Ratio: _____

GIS # Prj # ITD Key #
Est Source Proj Mgr

Replace/widen bridge #1216 over the Ten Mile Feeder Canal in advance of Eagle Rd, Amity Rd / Victory Rd widening. Connect existing sidewalks on west side of road. In-house design.

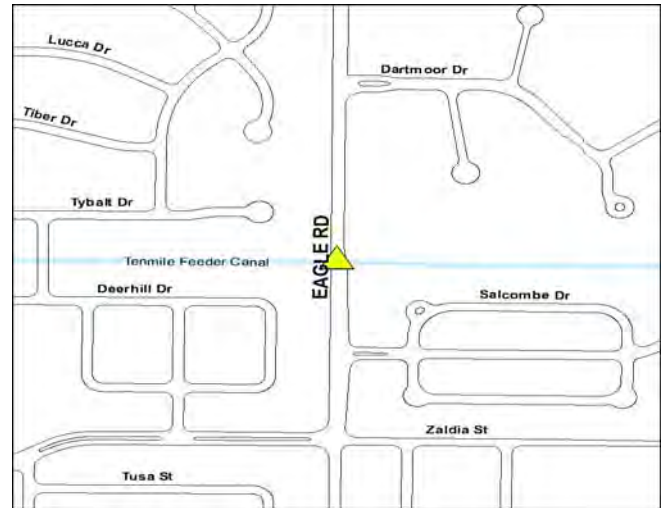

Programmed Expenditures			Project Costs	
Prof Services - DSN	\$1,000	2017	ACHD Share	\$198,000
Title Search - RW	\$1,000	2017	Plus Funding	\$0
Appraisals - RW	\$3,000	2017	Plus PriorCosts	
RW Acquisition	\$9,000	2017	Project Total	\$198,000
Construction	\$174,000	2018		
Const Engineering	\$7,000	2018		
Utilities	\$3,000	2017		
Programmed	\$198,000			

Eckert Rd Bridge #2147 and #2148, Boise River/ Ridenbaugh Canal Boise

Priority: _____ of _____
Adjusted 2015 Benefit/Cost Ratio: _____

GIS # Prj # ITD Key #
Est Source Proj Mgr

Replace bridge #2147 over the Boise River and bridge #2148 over the Ridenbaugh Canal as part of ACHD's Bridge Maintenance Program.

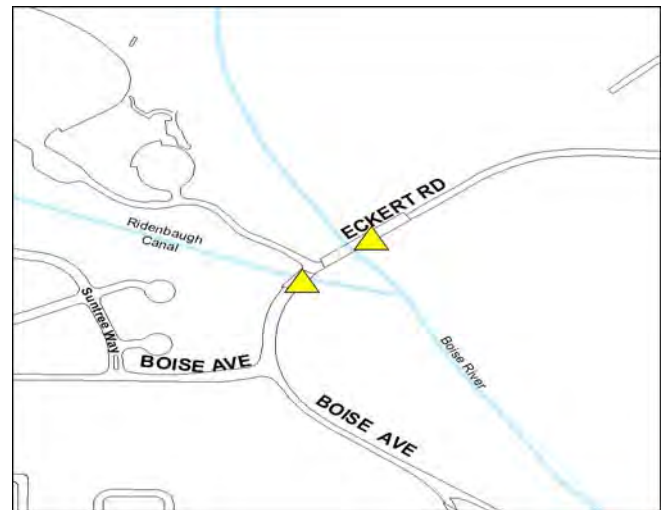

Programmed Expenditures			Project Costs	
Prof Services - DSN	\$500,000	UF	ACHD Share	\$5,855,000
Construction	\$5,355,000	UF	Plus Funding	\$0
Programmed	\$5,855,000		Plus PriorCosts	
			Project Total	\$5,855,000

Fairview Ave Bridge #2196 and #2197, Boise River Boise

Priority: _____ of _____
Adjusted 2015 Benefit/Cost Ratio: _____

GIS # Prj # ITD Key #
Est Source Proj Mgr

Replace bridges #2196 and #2197 over the Boise River as part of ACHD's Bridge Maintenance Program. Project is contingent upon federal aid.



Programmed Expenditures			Project Costs	
Prof Services - DSN	\$700,000	UF	ACHD Share	\$8,197,000
Construction	\$7,497,000	UF	Plus Funding	\$0
Programmed	\$8,197,000		Plus PriorCosts	
			Project Total	\$8,197,000

**Floating Feather Rd Bridge #1513, 0.1 miles E/O Palmer Ln
Eagle**

Priority: of
Adjusted 2015 Benefit/Cost Ratio:

GIS # Prj # ITD Key #

Est Source Proj Mgr

Replace bridge #1513 over Foothill Ditch on Floating Feather Rd as part of ACHD's Bridge Maintenance Program.



Programmed Expenditures			Project Costs	
Prof Services - DSN	\$22,000	UF	ACHD Share	\$127,000
Construction	\$105,000	UF	Plus Funding	\$0
Programmed	\$127,000		Plus PriorCosts	
			Project Total	\$127,000

**Gowen Rd Bridge #2110, W/O I-84
Boise**

Priority: of
Adjusted 2015 Benefit/Cost Ratio:

GIS # Prj # ITD Key #

Est Source Proj Mgr

Replace/widen bridge #2110 over the UPRR tracks to accommodate future widening of Gowen Rd.



Programmed Expenditures			Project Costs	
Prof Services - DSN	\$200,000	UF	ACHD Share	\$1,692,000
RW Acquisition	\$10,000	UF	Plus Funding	\$0
Construction	\$1,482,000	UF	Plus PriorCosts	
Programmed	\$1,692,000		Project Total	\$1,692,000

**Gowen Rd Bridge #2173, 1.35 miles S/O Victory Rd
Boise**

Priority: of
Adjusted 2015 Benefit/Cost Ratio:

GIS # Prj # ITD Key #

Est Source Proj Mgr

Replace bridge #2173 over the New York Canal on Gowen Rd as part of ACHD's Bridge Maintenance Program.

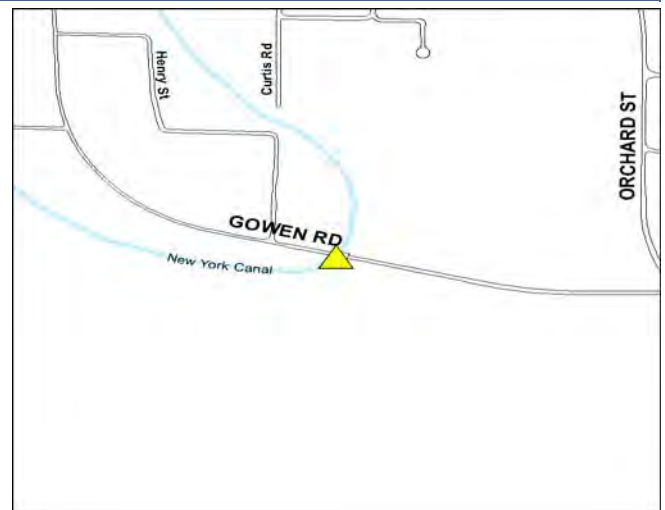

Programmed Expenditures			Project Costs	
Prof Services - DSN	\$353,000	2017	ACHD Share	\$2,265,800
Prof Services - DSN	\$15,000	2018	Plus Funding	\$0
Title Search - RW	\$1,000	2017	Plus PriorCosts	
RW Acquisition	\$2,000	2018	Project Total	\$2,265,800
Construction	\$1,860,000	2020		
Const Engineering	\$35,000	2020		
Programmed	\$2,266,000			

Hanley PI Bridge #1056, 700' N/O Chaparral Rd
Ada County

Priority: _____ of _____
 Adjusted 2015 Benefit/Cost Ratio: _____

GIS # Prj # ITD Key #

Est Source Proj Mgr

Replace bridge #1056 over Willow Creek on Hanley PI as part of ACHD's Bridge Maintenance Program.



Programmed Expenditures			Project Costs	
Prof Services - DSN	\$154,000	UF	ACHD Share	\$676,000
RW Acquisition	\$12,000	UF	Plus Funding	\$0
Construction	\$488,000	UF	Plus PriorCosts	
Const Engineering	\$16,000	UF	Project Total	\$676,000
Utilities	\$6,000	UF		
Programmed	\$676,000			

Jefferson St Bridge #1328, 180' W/O 14th St
Boise

Priority: _____ of _____
 Adjusted 2015 Benefit/Cost Ratio: _____

GIS # Prj # ITD Key #

Est Source Proj Mgr

Replace bridge #1328 over the Boise City Canal on Jefferson St in coordination with Downtown Boise Implementation Plan work. In-house design.



Programmed Expenditures			Project Costs	
Construction	\$155,000	2017	ACHD Share	\$155,000
Programmed	\$155,000		Plus Funding	\$0
			Plus PriorCosts	
			Project Total	\$155,000

Kuna Rd Bridge #1191, 0.3 miles W/O Black Cat Rd
Kuna

Priority: _____ of _____
 Adjusted 2015 Benefit/Cost Ratio: _____

GIS # Prj # ITD Key #

Est Source Proj Mgr

Replace bridge #1191 over the Benton Lateral on Kuna Rd as part of ACHD's Bridge Maintenance Program.



Programmed Expenditures			Project Costs	
Prof Services - DSN	\$80,000	2019	ACHD Share	\$487,000
RW Acquisition	\$2,000	2020	Plus Funding	\$0
Construction	\$392,000	2021	Plus PriorCosts	
Const Engineering	\$8,000	2021	Project Total	\$487,000
Utilities	\$5,000	2021		
Programmed	\$487,000			

Linder Rd Bridge #1021 and #1022, 0.3 miles N/O Hwy 44 Eagle

Priority: _____ of _____
Adjusted 2015 Benefit/Cost Ratio: _____

GIS # Prj # ITD Key #
Est Source Other Proj Mgr

Replace/widen bridge #1021 over the Middleton Mill Canal and bridge #1022 over the Foothills Ditch to accommodate future widening of Linder Rd.



Programmed Expenditures			Project Costs	
Prof Services - DSN	\$200,000	PD	ACHD Share	\$1,113,000
RW Acquisition	\$50,000	UF	Plus Funding	\$0
Construction	\$863,000	UF	Plus PriorCosts	
Programmed	\$1,113,000		Project Total	\$1,113,000

Linder Rd Bridge #2033 and #1078, 3/4 miles N/O Chinden Blvd Ada County

Priority: _____ of _____
Adjusted 2015 Benefit/Cost Ratio: _____

GIS # Prj # ITD Key #
Est Source Other Proj Mgr

Replace/widen bridge #2033 over the Phyllis Canal and bridge #1078 over the Eureka Canal to accommodate future widening of Linder Rd.

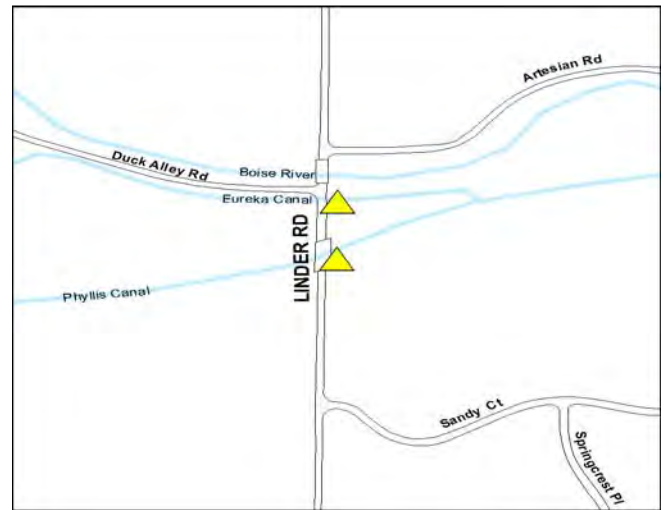

Programmed Expenditures			Project Costs	
Prof Services - DSN	\$200,000	PD	ACHD Share	\$988,000
RW Acquisition	\$55,000	UF	Plus Funding	\$0
Construction	\$733,000	UF	Plus PriorCosts	
Programmed	\$988,000		Project Total	\$988,000

Locust Grove Rd Bridge #1299, 1800' N/O King Rd Ada County

Priority: _____ of _____
Adjusted 2015 Benefit/Cost Ratio: _____

GIS # Prj # ITD Key #
Est Source Proj Mgr

Replace bridge #1299 over Indian Creek on Locust Grove Rd as part of ACHD's Bridge Maintenance Program. A temporary bypass will be needed since this is a dead end road.



Programmed Expenditures			Project Costs	
Prof Services - DSN	\$5,000	2017	ACHD Share	\$321,000
Construction	\$311,000	2017	Plus Funding	\$0
Const Engineering	\$5,000	2017	Plus PriorCosts	
Programmed	\$321,000		Project Total	\$321,000

Mallard Ave Bridge #1339, 650' W/O Parkcenter Blvd
Boise

Priority: _____ of _____
 Adjusted 2015 Benefit/Cost Ratio: _____

GIS # Prj # ITD Key #
 Est Source Proj Mgr

Replace bridge #1339 over Loggers Creek on Mallard Ave as part of ACHD's Bridge Maintenance Program.



Programmed Expenditures			Project Costs	
Prof Services - DSN	\$157,000	PD	ACHD Share	\$801,000
Construction	\$623,000	PD	Plus Funding	\$0
Const Engineering	\$16,000	PD	Plus PriorCosts	
Utilities	\$5,000	PD	Project Total	\$801,000
Programmed	\$801,000			

McMillan Rd Bridge #2060, 1650' W/O Star Rd
Ada County

Priority: _____ of _____
 Adjusted 2015 Benefit/Cost Ratio: _____

GIS # Prj # ITD Key #
 Est Source Proj Mgr

Replace bridge #2060 over Phyllis Canal on McMillan Rd as part of ACHD's Bridge Maintenance Program.



Programmed Expenditures			Project Costs	
Prof Services - DSN	\$100,000	PD	ACHD Share	\$356,000
Construction	\$256,000	PD	Plus Funding	\$0
Programmed	\$356,000		Plus PriorCosts	
			Project Total	\$356,000

Mitchell St Bridge #1453, 200' N/O Arabian Dr
Boise

Priority: _____ of _____
 Adjusted 2015 Benefit/Cost Ratio: _____

GIS # Prj # ITD Key #
 Est Source Proj Mgr

Replace bridge #1453 over the Ten Mile Feeder Canal on Mitchell St as part of ACHD's Bridge Maintenance Program.



Programmed Expenditures			Project Costs	
Prof Services - DSN	\$42,000	PD	ACHD Share	\$221,000
Construction	\$172,000	PD	Plus Funding	\$0
Const Engineering	\$4,000	PD	Plus PriorCosts	
Utilities	\$3,000	PD	Project Total	\$221,000
Programmed	\$221,000			

Munger Rd Bridge #1005 and #2001, 1/2 mile S/O New Hope Rd Star

Priority: _____ of _____
Adjusted 2015 Benefit/Cost Ratio: _____

GIS # Prj # ITD Key #
Est Source Other Proj Mgr

Replace bridge #1005 over the Dry Creek Canal and bridge #2001 over the Middleton Canal as part of ACHD's Bridge Maintenance Program. Road Trust Funds are available for this project.



Programmed Expenditures			Project Costs	
RW Acquisition	\$100,000	2019	ACHD Share	\$982,000
Construction	\$931,000	2021	Plus Funding	\$49,000
Programmed	\$1,031,000		Plus PriorCosts	
			Project Total	\$1,031,000

Munger Rd Bridge #1462, 550' S/O New Hope Rd Boise

Priority: _____ of _____
Adjusted 2015 Benefit/Cost Ratio: _____

GIS # Prj # ITD Key #
Est Source Planning Proj Mgr

Replace bridge #1462 over Foothill Ditch on Munger Rd as part of ACHD's Bridge Maintenance Program.



Programmed Expenditures			Project Costs	
Prof Services - DSN	\$45,000	PD	ACHD Share	\$256,000
Title Search - RW	\$1,000	PD	Plus Funding	\$0
Appraisals - RW	\$12,000	PD	Plus PriorCosts	
RW Acquisition	\$16,000	PD	Project Total	\$256,000
Construction	\$174,000	PD		
Const Engineering	\$5,000	PD		
Utilities	\$3,000	PD		
Programmed	\$256,000			

Osage St Bridge #1451, 50' E/O 46th St Garden City

Priority: _____ of _____
Adjusted 2015 Benefit/Cost Ratio: _____

GIS # Prj # ITD Key #
Est Source Scoping 2014 Proj Mgr

Replace bridge #1451 over Thurman Mill Canal on Osage St as part of ACHD's Bridge Maintenance Program. Bridge to be constructed concurrently with 46th St Bridge #1452. In-house design.

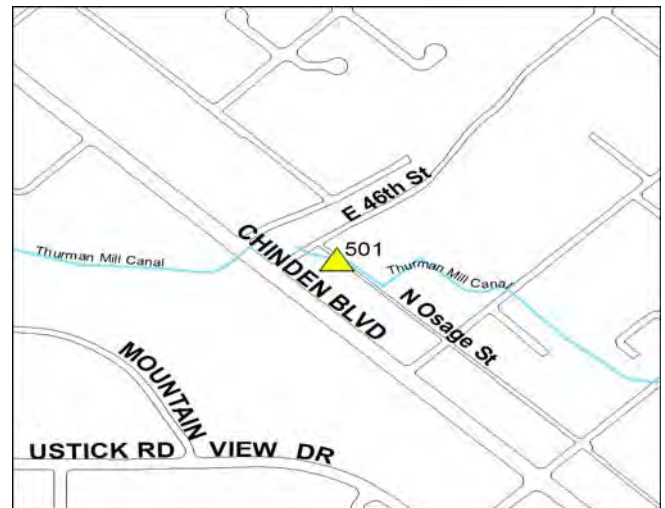

Programmed Expenditures			Project Costs	
Prof Services - DSN	\$30,000	2017	ACHD Share	\$248,800
Title Search - RW	\$0	2017	Plus Funding	\$0
Title Search - RW	\$0	2018	Plus PriorCosts	
RW Acquisition	\$2,000	2018	Project Total	\$248,800
Construction	\$209,000	2019		
Const Engineering	\$5,000	2019		
Utilities	\$2,000	2017		
Programmed	\$248,000			

Palmer Ln Bridge #1009, N/O Floating Feather Rd

Eagle

Priority: _____ of _____
Adjusted 2015 Benefit/Cost Ratio: _____

GIS # Prj # ITD Key #

Est Source Proj Mgr

Replace bridge #1009 over Foothill Ditch on Palmer Ln as part of ACHD's Bridge Maintenance Program.

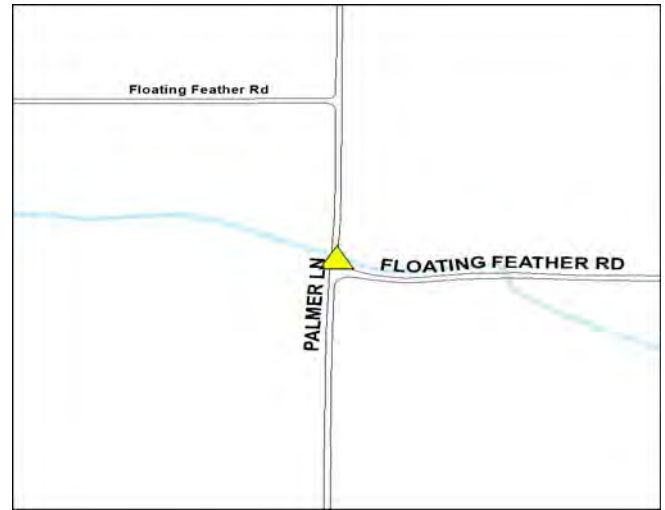

Programmed Expenditures			Project Costs	
Prof Services - DSN	\$30,000	UF	ACHD Share	\$155,000
Construction	\$125,000	UF	Plus Funding	\$0
Programmed	\$155,000		Plus PriorCosts	
			Project Total	\$155,000

Parkinson St Bridge #1450, 0.1 miles N/O State St

Eagle

Priority: _____ of _____
Adjusted 2015 Benefit/Cost Ratio: _____

GIS # Prj # ITD Key #

Est Source Proj Mgr

Replace bridge #1450 over Spoils Bank Canal on Parkinson St as part of ACHD's Bridge Maintenance Program. In-house design.



Programmed Expenditures			Project Costs	
Prof Services - DSN	\$0	2017	ACHD Share	\$165,000
Title Search - RW	\$1,000	2017	Plus Funding	\$0
RW Acquisition	\$2,000	2018	Plus PriorCosts	
Construction	\$155,000	2019	Project Total	\$165,000
Const Engineering	\$5,000	2019		
Utilities	\$2,000	2017		
Programmed	\$165,000			

Phillippi St Bridge #1366, 650' N/O Overland Rd

Boise

Priority: _____ of _____
Adjusted 2015 Benefit/Cost Ratio: _____

GIS # Prj # ITD Key #

Est Source Proj Mgr

Replace bridge #1366 over Farmers Lateral on Phillippi St as part of ACHD's Bridge Maintenance Program.



Programmed Expenditures			Project Costs	
Prof Services - DSN	\$125,000	UF	ACHD Share	\$346,000
Construction	\$221,000	UF	Plus Funding	\$0
Programmed	\$346,000		Plus PriorCosts	
			Project Total	\$346,000

**Pierce Park Ln Bridge #2029, at Hill Rd
Boise**

Priority: _____ of _____
Adjusted 2015 Benefit/Cost Ratio: _____

GIS # Prj # ITD Key #
Est Source Proj Mgr

Replace bridge #2029 over the Farmers Union Canal on Pierce Park Ln as part of ACHD's Bridge Maintenance Program.



Programmed Expenditures			Project Costs	
Prof Services - DSN	\$185,000	2021	ACHD Share	\$970,000
Construction	\$785,000	PD	Plus Funding	\$0
Programmed	\$970,000		Plus PriorCosts	
			Project Total	\$970,000

**Rackham Way Bridge #1223, 0.1 miles N/O Overland Rd
Meridian**

Priority: _____ of _____
Adjusted 2015 Benefit/Cost Ratio: _____

GIS # Prj # ITD Key #
Est Source Proj Mgr

Replace bridge #1223 over Five Mile Creek on Rackham Way as part of ACHD's Bridge Maintenance Program.



Programmed Expenditures			Project Costs	
Prof Services - DSN	\$93,000	2019	ACHD Share	\$611,000
Construction	\$497,000	2021	Plus Funding	\$0
Const Engineering	\$14,000	2021	Plus PriorCosts	
Utilities	\$7,000	2021	Project Total	\$611,000
Programmed	\$611,000			

**Reutzel Ave Bridge #1247, 550' E/O Cloverdale Rd
Boise**

Priority: _____ of _____
Adjusted 2015 Benefit/Cost Ratio: _____

GIS # Prj # ITD Key #
Est Source Proj Mgr

Replace bridge #1247 over Ten Mile Feeder Canal on Reutzel Dr as part of ACHD's Bridge Maintenance Program.



Programmed Expenditures			Project Costs	
Prof Services - DSN	\$35,000	PD	ACHD Share	\$153,000
Construction	\$112,000	PD	Plus Funding	\$0
Const Engineering	\$4,000	PD	Plus PriorCosts	
Utilities	\$2,000	PD	Project Total	\$153,000
Programmed	\$153,000			

**Shamrock Ave Bridge #1424, 0.1 miles N/O Fairview Ave
Boise**

Priority: _____ of _____
Adjusted 2015 Benefit/Cost Ratio:

GIS # MI215-09 Prj # _____ ITD Key # _____
Est Source Scoping 2015 Proj Mgr Kuperus

Replace bridge #1424 over the South Slough on Shamrock Ave as part of ACHD's Bridge Maintenance Program.

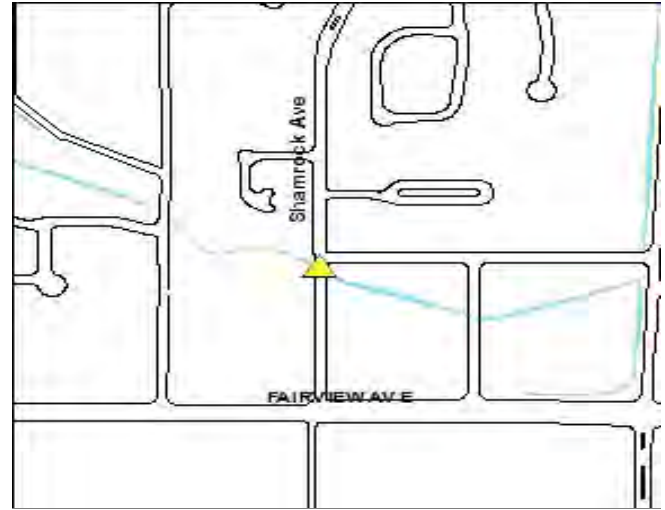

Programmed Expenditures			Project Costs	
Prof Services - DSN	\$36,000	2020	ACHD Share	\$214,000
Title Search - RW	\$1,000	2020	Plus Funding	\$0
Appraisals - RW	\$8,000	2020	Plus PriorCosts	
RW Acquisition	\$29,000	2021	Project Total	\$214,000
Construction	\$134,000	PD		
Const Engineering	\$4,000	PD		
Utilities	\$2,000	PD		
Programmed	\$214,000			

**Smith Ave Bridge #1315, 250' E/O 26th St
Boise**

Priority: _____ of _____
Adjusted 2015 Benefit/Cost Ratio:

GIS # MI214-11 Prj # 216009 ITD Key # _____
Est Source Scoping 2014 Proj Mgr Calderon

Replace bridge #1315 over Boise City Canal on Smith Ave as part of ACHD's Bridge Maintenance Program.



Programmed Expenditures			Project Costs	
Prof Services - DSN	\$1,000	2017	ACHD Share	\$142,000
RW Acquisition	\$8,000	2017	Plus Funding	\$0
Construction	\$128,000	2018	Plus PriorCosts	
Const Engineering	\$5,000	2018	Project Total	\$142,000
Programmed	\$142,000			

**Spangler PI Bridge #1054, 0.4 miles N/O Chaparral Rd
Ada County**

Priority: _____ of _____
Adjusted 2015 Benefit/Cost Ratio:

GIS # MA215-04 Prj # _____ ITD Key # _____
Est Source Planning Proj Mgr Kuperus

Replace bridge #1054 over Willow Creek on Spangler PI as part of ACHD's Bridge Maintenance Program.

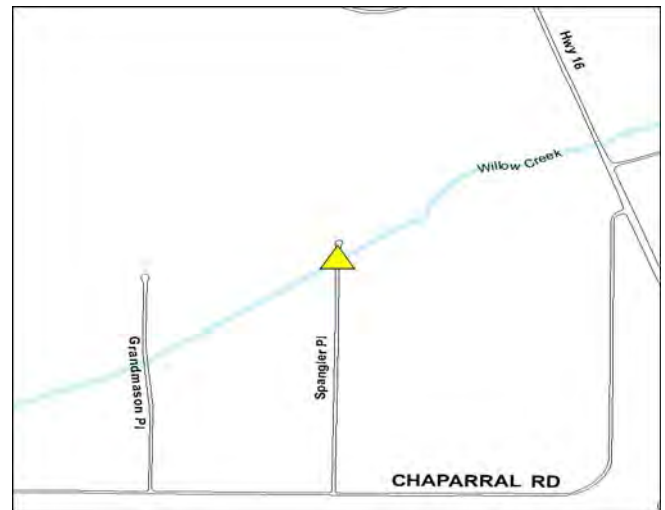

Programmed Expenditures			Project Costs	
Prof Services - DSN	\$120,000	UF	ACHD Share	\$604,000
RW Acquisition	\$12,000	UF	Plus Funding	\$0
Construction	\$450,000	UF	Plus PriorCosts	
Const Engineering	\$16,000	UF	Project Total	\$604,000
Utilities	\$6,000	UF		
Programmed	\$604,000			

Star Rd Bridge #1093, 0.25 miles S/O McMillan Rd
Ada County

Priority: _____ of _____
 Adjusted 2015 Benefit/Cost Ratio: _____

GIS # Prj # ITD Key #
 Est Source Proj Mgr

Replace bridge #1093 over Lawrence Kennedy Canal on Star Rd as part of ACHD's Bridge Maintenance Program.



Programmed Expenditures			Project Costs	
Prof Services - DSN	\$123,000	PD	ACHD Share	\$688,000
Title Search - RW	\$1,000	PD	Plus Funding	\$0
Appraisals - RW	\$8,000	PD	Plus PriorCosts	
RW Acquisition	\$29,000	PD	Project Total	\$688,000
Construction	\$508,000	PD		
Const Engineering	\$12,000	PD		
Utilities	\$7,000	PD		
Programmed	\$688,000			

State St Bridge #1408, 0.2 miles W/O Collister Dr
Boise

Priority: _____ of _____
 Adjusted 2015 Benefit/Cost Ratio: _____

GIS # Prj # ITD Key #
 Est Source Proj Mgr

Replace bridge #1408 over the Boise Valley Canal on State St as part of ACHD's Bridge Maintenance Program. Project to be constructed concurrently with the State St and Collister Dr intersection project.



Programmed Expenditures			Project Costs	
Construction	\$400,000	2018	ACHD Share	\$400,000
Programmed	\$400,000		Plus Funding	\$0
			Plus PriorCosts	\$23,900
			Project Total	\$423,900

State St Bridge #1486, at 15th St
Boise

Priority: _____ of _____
 Adjusted 2015 Benefit/Cost Ratio: _____

GIS # Prj # ITD Key #
 Est Source Proj Mgr

Replace bridge #1486 over the Boise City Canal on State St in coordination with Downtown Boise Implementation Plan work.



Programmed Expenditures			Project Costs	
Prof Services - DSN	\$50,000	2017	ACHD Share	\$895,300
Title Search - RW	\$0	2017	Plus Funding	\$0
RW Acquisition	\$15,000	2017	Plus PriorCosts	
Construction	\$803,000	2018	Project Total	\$895,300
Const Engineering	\$12,000	2018		
Traffic Materials	\$15,000	2018		
Programmed	\$895,000			

Stroebe Rd Bridge #1208, 2300' S/O Kuna Rd
Ada County

Priority: _____ of _____
 Adjusted 2015 Benefit/Cost Ratio: _____

GIS # Prj # ITD Key #
 Est Source Proj Mgr

Replace bridge #1208 over Indian Creek on Stroebel Rd as part of ACHD's Bridge Maintenance Program.



Programmed Expenditures			Project Costs	
Prof Services - DSN	\$5,000	2017	ACHD Share	\$382,000
Construction	\$372,000	2017	Plus Funding	\$0
Const Engineering	\$5,000	2017	Plus PriorCosts	
Programmed	\$382,000		Project Total	\$382,000

Victory Rd Bridge #1275, 1/4 mile E/O Locust Grove Rd
Ada County / Meridian

Priority: _____ of _____
 Adjusted 2015 Benefit/Cost Ratio: _____

GIS # Prj # ITD Key #
 Est Source Proj Mgr

Replace/widen bridge #1275 over the Eight Mile Lateral on Victory Rd as part of ACHD's Bridge Maintenance Program.



Programmed Expenditures			Project Costs	
Construction	\$618,000	2018	ACHD Share	\$623,000
Utilities	\$5,000	2018	Plus Funding	\$0
Programmed	\$623,000		Plus PriorCosts	\$47,145
			Project Total	\$670,145

Walnut St Bridge #1501, 450' S/O Warm Springs Ave
Boise

Priority: _____ of _____
 Adjusted 2015 Benefit/Cost Ratio: _____

GIS # Prj # ITD Key #
 Est Source Proj Mgr

Replace bridge #1501 over Boise City Canal on Walnut St as part of ACHD's Bridge Maintenance Program.



Programmed Expenditures			Project Costs	
Prof Services - DSN	\$75,000	UF	ACHD Share	\$209,000
Construction	\$134,000	UF	Plus Funding	\$0
Programmed	\$209,000		Plus PriorCosts	
			Project Total	\$209,000