

TYPICAL POSTING FOR U-TURNS AT SIGNALIZED INTERSECTIONS

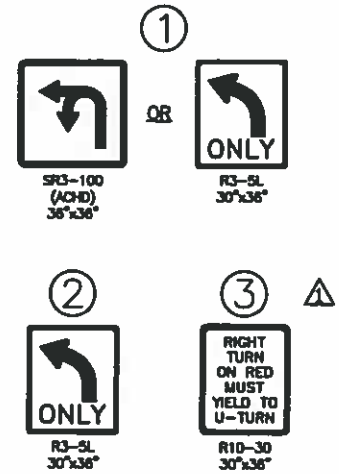
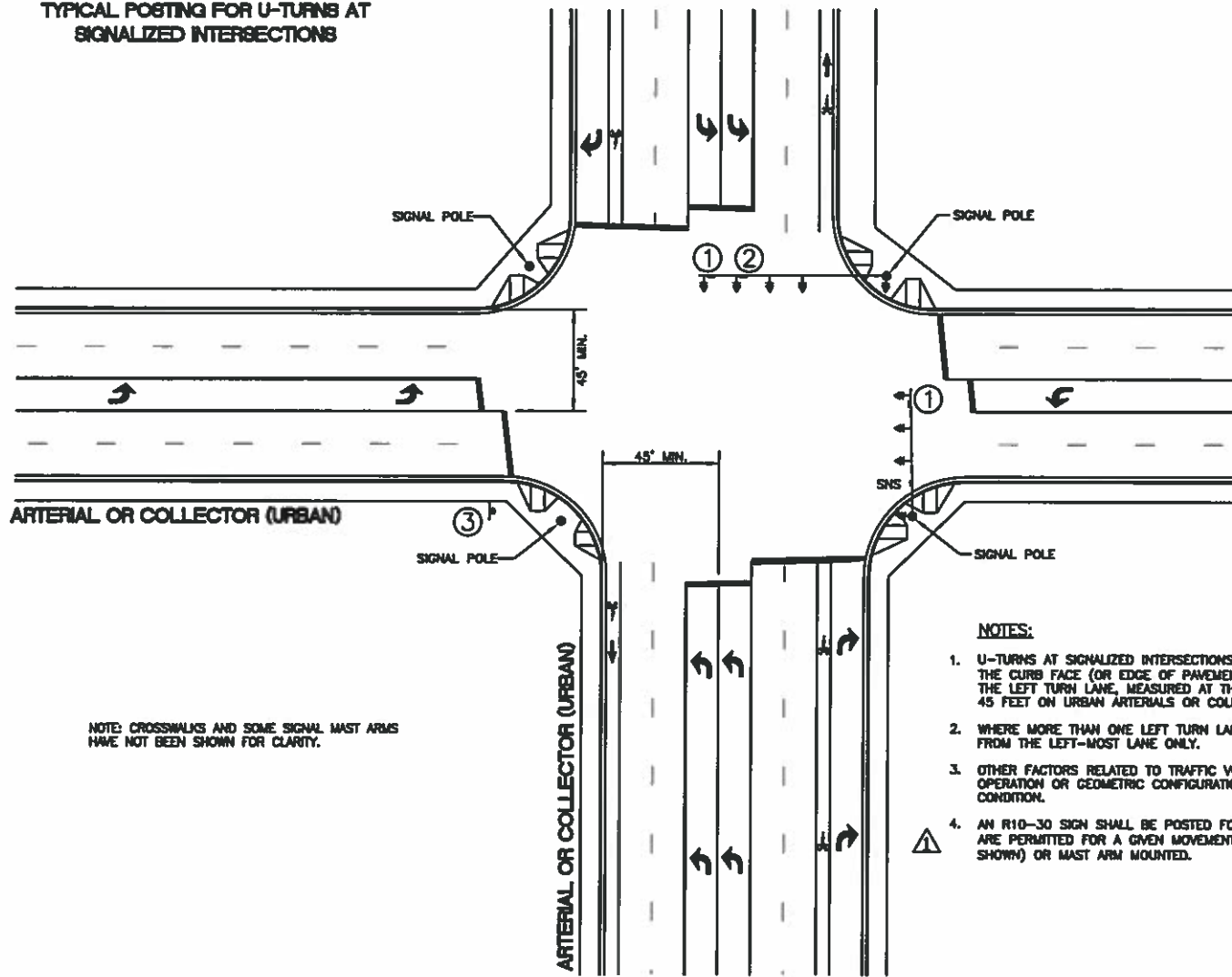

NOTE: CROSSWALKS AND SOME SIGNAL MAST ARMS HAVE NOT BEEN SHOWN FOR CLARITY.

NOTES:

1. U-TURNS AT SIGNALIZED INTERSECTIONS MAY BE PERMITTED IF THE DISTANCE FROM THE CURB FACE (OR EDGE OF PAVEMENT, IF NO CURB EXISTS) TO THE RIGHT SIDE OF THE LEFT TURN LANE, MEASURED AT THE STOP BAR, IS EQUAL TO OR GREATER THAN 45 FEET ON URBAN ARTERIALS OR COLLECTORS.
2. WHERE MORE THAN ONE LEFT TURN LANE IS PRESENT, U-TURNS SHALL BE PERMITTED FROM THE LEFT-MOST LANE ONLY.
3. OTHER FACTORS RELATED TO TRAFFIC VOLUMES, SPEED LIMITS, SIGHT DISTANCE, SIGNAL OPERATION OR GEOMETRIC CONFIGURATION MAY PREVENT POSTING OF A U-TURN CONDITION.
4. AN R10-30 SIGN SHALL BE POSTED FOR THE CONFLICTING RIGHT TURN IF U-TURNS ARE PERMITTED FOR A GIVEN MOVEMENT. R10-30 SIGNS MAY BE POST MOUNTED (AS SHOWN) OR MAST ARM MOUNTED.

12/21/2016





- SIGNATURES -		- CHECKED BY -	
Drawn By: Justin Stank	Checked By: Justin Stank		
Scale: 1/8"=1'-0"			
File: TS-1120.01.dwg	Approved By: Erin Gray		

U-Turns at Signalized Intersections

TS-1120.01
Sheet 1 of 1